



GreenSpace Accent Projector Gen1

ST320T LED49S/827 PSU MB WH

GREENSPACE ACCENT PROJECTOR, LED module, system flux 4900 lm, 827 warm white, Power supply unit (On/Off), Medium beam, White

Thanks to the GreenSpace Accent family, retailers and building operators can now make the switch from CDM to LED and enjoy the benefits of Philips PerfectAccent light quality as well as significant energy savings – all for a reasonable initial investment. GreenSpace Accent Projector's regular 3C adaptor and specific lumen packages make retrofit installation quick and easy. For fashion and food retailers, the GreenSpace Accent Projector is available with special light flavours and LED recipes to show the clothes and fresh food produce on offer in the very best light. Check out our Fashion and Food catalogue pages to find out more about CrispWhite, PremiumWhite, Fresh Food Meat and Fresh Food Champagne.

Product data

General Information		Warranty period	
Lamp family code	LED49S [LED module, system flux 4900 lm]	Flammability mark	5 years
Light source replaceable	No	For mounting on normally flammable surfaces	
Number of gear units	1 unit	ENEC mark	ENEC mark
Driver included	Yes	Glow-wire test	Temperature 650 °C, duration 5 s
Service tag	Yes	EU RoHS compliant	Yes
Product family code	ST320T [GREENSPACE ACCENT PROJECTOR]	Light Technical	
Lighting Technology	LED	Luminous Flux	4,750 lm
CE mark	Yes	Correlated Color Temperature (Nom)	2700 K
		Luminous Efficacy (rated) (Nom)	118.75 lm/W

GreenSpace Accent Projector Gen1

Color rendering index (CRI)	≥80
Beam angle of light source	120 degree(s)
Light source color	827 warm white
Optic type	Medium beam
Optical cover type	Polymethyl methacrylate bowl/cover
Luminaire light beam spread	24°
Unified glare rating CEN	Not applicable

Operating and Electrical

Input Voltage	220-240 V
Line Frequency	50 to 60 Hz
Inrush current	18 A
Inrush time	0.250 ms
Power Consumption	40 W
Power Factor (Fraction)	0.9
Connection	-
Cable	-
Number of products on MCB of 16 A type B	20

Temperature

Ambient temperature range	+10 to +40 °C
---------------------------	---------------

Controls and Dimming

Dimmable	No
Driver/power unit/transformer	Power supply unit (On/Off)
Constant light output	No

Mechanical and Housing

Housing Material	Aluminum
Reflector material	Polycarbonate aluminum coated
Optic material	Polycarbonate
Optical cover material	Polymethyl methacrylate
Fixation material	Polyamide
Housing Color	White
Optical cover finish	Clear
Overall length	182 mm
Overall width	114 mm

Overall height	193 mm
Dimensions (Height x Width x Depth)	193 x 114 x 182 mm

Approval and Application

Ingress protection code	IP20 [Finger-protected]
Mech. impact protection code	IK02 [0.2 J standard]
Protection class IEC	Safety class II

Initial Performance (IEC Compliant)

Luminous flux tolerance	+/-10%
Initial chromaticity	(0.45, 0.41) SDCM<3
Power consumption tolerance	+/-10%

Over Time Performance (IEC Compliant)

Driver failure rate at 5000 h	1 %
Control gear failure rate at median useful life 50000 h	5 %
Lumen maintenance at median useful life* 50000 h	L80

Application Conditions

Performance ambient temperature Tq	25 °C
Suitable for random switching	Yes

Product Data

Order product name	ST320T LED49S/827 PSU MB WH
Full product name	ST320T LED49S/827 PSU MB WH
Full product code	871869940337900
Order code	40337900
Material Nr. (12NC)	910500465414
Numerator - Quantity Per Pack	1
EAN/UPC - Product/Case	8718699403379
Numerator - Packs per outer box	1
EAN/UPC - Case	8718699403379

Dimensional drawing

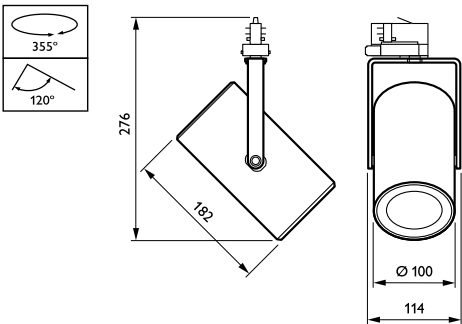

GreenSpace Accent Projector Gen1

