

SmartForm TBS411

TBS411 1x35W/840 HFP MLO-PC PIP

SmartForm recessed semi-modular, 1, 35 W, 840 neutral white, HF Performer, Micro-lens optic in polycarbonate cover, Push-in connector and pull relief

Reflecting Philips' drive for simplicity and sustainability, SmartForm recessed is a complete family of highly versatile modular and semi-modular luminaires. These luminaires are available with a choice of LED or MASTER TL5 light sources in very small, slender versions. Designed to fit in a wide range of ceiling types, this complete family can fulfill the majority of project requirements in most applications. As well as incorporating energy-efficient light sources and electronic ballasts, the SmartForm recessed family can be equipped with lighting controls. These include solutions for presence detection and daylight regulation (ActiLume) or daylight regulation only (Luxsense), thereby further reducing energy consumption (W/m^2 is very low). In this way, this Green Flagship range lowers overall cost of ownership as well as CO₂ levels, making SmartForm an environmentally friendly choice. These slender SmartForm recessed luminaires are designed for integration in variety of linear ceiling systems: exposed and concealed T-bar, plaster and the extended versions for bandraster ceilings. Micro-optics and covers (MLO-PC and Opal) in smallest concept, width 90 mm. Modular length 600, 900, 1200 and 1500 mm. To extend till 2400 mm. Micro-optics and covers in smallest concept with AIR function, width 100 mm. Modular length 600, 900, 1200 and 1500 mm. To extend till 2400 mm. Mini-optics, 2-lamps, width 115 mm. Modular length 600, 900, 1200 and 1500 mm. To extend till 2400 mm.

Product data

General Information			
Lamp family code	TL5 [TL5]	Feed-through wiring	-
Gear	HFP [HF Performer]	Product family code	TBS411 [SmartForm recessed semi-modular]
		Embedded control	-

SmartForm TBS411

CE mark	Yes
Glow-wire test	Temperature 850 °C, duration 5 s
Light Technical	
Number of light sources	1
Light source color	840 neutral white
Optic type	-
Optical cover type	Micro-lens optic in polycarbonate cover
Operating and Electrical	
Input Voltage	220 to 240 V
Power Consumption	35 W
Connection	Push-in connector and pull relief
Cable	-
Mechanical and Housing	
Housing Color	White
Overall length	1,497 mm
Approval and Application	
Ingress protection code	IP40 [Wire-protected]

Mech. impact protection code	IK02 [0.2 J standard]
Protection class IEC	Safety class I
Application Conditions	
Suitable for random switching	Not applicable
Product Data	
Order product name	TBS411 1x35W/840 HFP MLO-PC PIP
Full product name	TBS411 1x35W/840 HFP MLO-PC PIP
Full product code	871794398684200
Order code	910501889603
Material Nr. (12NC)	910501889603
Numerator - Quantity Per Pack	1
EAN/UPC - Product/Case	8717943986842
Numerator - Packs per outer box	1
EAN/UPC - Case	8717943986842

Dimensional drawing

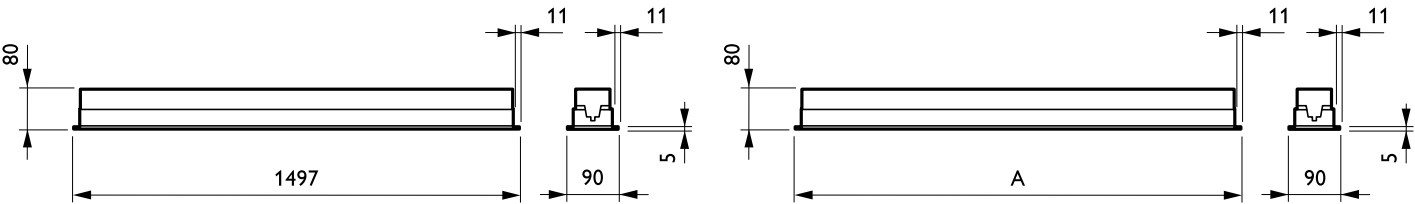

Product	A
TBS411 1x35W/840 HFP MLO-PC PIP	1,497 mm

