



AmphiLux, recessed

BBD400 1xLED-HB/BL 12V 10

1 pc - LED High Brightness - Narrow beam angle 10°

People want to spend more quality time outdoors with family and friends. The AmphiLux recessed spotlight range is designed to enhance outdoor social areas (gardens, terraces, fountains, waterfalls, etc.) with architectural lighting. AmphiLux is a family of LED spots featuring a stunning, sleek Italian design with a stylish chrome finish. These solutions can be used under water and in semi-wet and dry environments. Available in Micro, Mini and Compact sizes, the range offers a choice of dynamic white-light and colored-light versions for maximum flexibility in tasteful flood and accent lighting.

Product data

General Information		Operating and Electrical	
Number of light sources	1 pc	Input Voltage	12 V
Lamp family code	LED-HB [LED High Brightness]		
Light source color	Blue	Controls and Dimming	
Light source replaceable	No	Dimmable	No
Driver/power unit/transformer	-		
Driver included	No	Approval and Application	
Optical cover/lens type	-	Ingress protection code	IP68 [Dust penetration-protected, pressure watertight]
Protection class IEC	Safety class III	Mech. impact protection code	IK10 [20 J vandal-resistant]
CE mark	CE mark		
Lifetime to 50% luminous flux	200000 h	Initial Performance (IEC Compliant)	
Lifetime to 70% luminous flux	147000 h	Initial luminous flux (system flux)	14 lm
Lifetime to 90% luminous flux	43000 h	Initial LED luminaire efficacy	9 lm/W
Optic type outdoor	Narrow beam angle 10°	Initial input power	1.5 W
Serviceability class	Class C, luminaire without serviceable parts, not serviceable		

AmphiLux, recessed

Application Conditions	
Ambient temperature range	-20 to +35 °C
Product Data	
Full product code	871794389316499
Order product name	BBD400 1xLED-HB/BL 12V 10
EAN/UPC - Product	8717943893164
Order code	910503673218

Numerator - Quantity Per Pack	1
Numerator - Packs per outer box	6
Material Nr. (12NC)	910503673218
Net Weight (Piece)	0.335 kg



Dimensional drawing

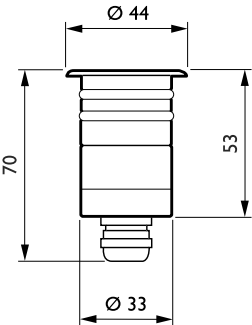

AmphiLux BBD/BVD400

