



# eW Profile Powercore

## ZCX411 C457P-M-F BK CE

Jumper Cable - 100 / 220 – 240 VAC - 457 mm (18 in) - Black

Jumper Cable - 100 / 220 – 240 VAC - 457 mm (18 in) - Black

### Product data

| General Information     |                              |
|-------------------------|------------------------------|
| Type description        | JUMPER CABLE [ Jumper cable] |
| Suspension accessories  | No [-]                       |
| Packaging configuration | No [-]                       |
| Accessory color         | Black                        |

| Operating and Electrical |   |
|--------------------------|---|
| Electrical accessories   | C457P-M-F [ Cable 457 mm with plug male and female] |
| Input Voltage            | 230 V   |

| Mechanical and Housing |        |
|------------------------|--------|
| Length                 | 460 mm |

| Product Data                    |                        |
|---------------------------------|------------------------|
| Full product code               | 871794370084499        |
| Order product name              | ZCX411 C457P-M-F BK CE |
| EAN/UPC - Product               | 8717943700844          |
| Order code                      | 910503700491           |
| Numerator - Quantity Per Pack   | 1                      |
| Numerator - Packs per outer box | 32                     |
| Material Nr. (12NC)             | 910503700491           |
| Net Weight (Piece)              | 0.080 kg               |

# eW Profile Powercore

## Dimensional drawing

Jumper / Leader Cable

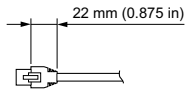

Jumper / Leader Cable

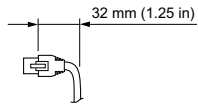

End-to-End Connector

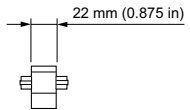

Terminator

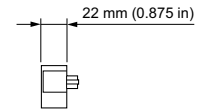

eW Profile Powercore acc. ZCX411

