



iW Graze MX Powercore

iW Graze MX Powercore, 30° x 60° Beam Angle, 305 mm (1 ft)

iW Graze MX Powercore, 30° x 60° Beam Angle, 305 mm (1 ft)

Many architectural structures need a linear fixture capable of illuminating multiple storeys with minimal setback. Property owners/end users need a controllable product capable of dynamic illumination to draw attention to their establishments and emphasize their brands. Graze MX Powercore is capable of illuminating over 20 meters at very close setback distances. Powercore technology enables simple installation and long product run lengths.

Product data

General Information		Controls and Dimming	
Lamp family code	LED-HB [LED High Brightness]	Dimmable	Yes
Light source replaceable	No		
Driver included	Yes	Mechanical and Housing	
Luminaire light beam spread	30° x 60°	Housing material	Aluminum extruded
Protection class IEC	Safety class I (I)	Optic material	Polycarbonate
CE mark	CE mark	Optical cover/lens material	Polycarbonate
UL mark	UL and cUL mark	Length	305 mm
		Colour	Aluminum
Operating and Electrical		Approval and Application	
Input Voltage	100 to 277 V	Ingress protection code	IP66 [Dust penetration-protected, jet-proof]
Input frequency	50 to 60 Hz	Mech. impact protection code	IK10 [20 J vandal-resistant]
		Vibration standard	Complies with ANSI C136.31, 3G

iW Graze MX Powercore

Vibration rating	Complies with ANSI C136.31, 3G
Initial Performance (IEC Compliant)	
Initial input power	20 W
Over Time Performance (IEC Compliant)	
Lumen Maintenance 50% at 25 °C Reported	60000
Lumen Maintenance 50% at 50 °C Reported	60000
Lumen Maintenance 70% at 25 °C Reported	60000
Lumen Maintenance 70% at 50 °C Reported	60000
Application Conditions	
Ambient temperature range	-40 to +50 °C

Product Data	
Full product code	871829160972899
Order product name	BCS429 30x60/2700-6500 L305
EAN/UPC – product	8718291609728
Order code	523-000079-03
SAP numerator – quantity per pack	1
Numerator – packs per outer box	4
SAP material	910503703647
SAP net weight (piece)	1.200 kg
Commercial Code	523-000079-03
Catalogue number description	iW Graze MX Powercore, 30° x 60° Beam Angle, 305 mm (1 ft)



Dimensional drawing

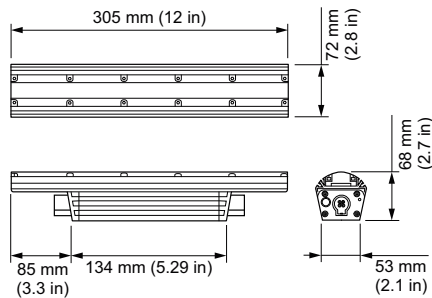

Graze

