



# eW Graze QLX Powercore

## BCS427 9/5500 L305

eW Graze QLX Powercore, 5500 K, 9° x 9° Beam Angle, 305 mm (1 ft)

Many architectural structures need a linear fixture capable of illuminating several storeys with minimal setback and reduced power consumption. Property owners/end users need a controllable product capable of dynamic illumination to draw attention to their establishments and emphasize their brands. Graze QLX Powercore is capable of illuminating over 10 meters at very close setback distances. Powercore technology enables simple installation and long product run lengths.

### Product data

| General Information           |                                       | Input frequency              |   |
|-------------------------------|---------------------------------------|------------------------------|---|
| Lamp family code              | LED-HB [ LED High Brightness]         | 50 to 60 Hz                  |   |
| Light source colour           | Cool white                            | Controls and Dimming         |   |
| Light source replaceable      | No                                    | Dimmable                     | Yes   |
| Driver included               | Yes                                   | Mechanical and Housing       |   |
| Optical cover/lens type       | PCC [ Polycarbonate bowl/cover clear] | Housing material             | Aluminum extruded                             |
| Luminaire light beam spread   | 9° x 9°                               | Optical cover/lens material  | Polycarbonate                                 |
| Protection class IEC          | Safety class I (I)                    | Length                       | 305 mm  |
| CE mark                       | CE mark                               | Colour                       | Aluminum                                      |
| UL mark                       | UL and cUL mark                       | Approval and Application     |   |
| Lifetime to 70% luminous flux | 100000 h                              | Ingress protection code      | IP66 [ Dust penetration-protected, jet-proof] |
| Operating and Electrical      |                                       | Mech. impact protection code | IK10 [ 20 J vandal-resistant]                 |
| Input Voltage                 | 100 to 277 V                          |                              |   |

# eW Graze QLX Powercore

|  |                                |
|--|--------------------------------|
| Vibration standard                           | Complies with ANSI C136.31, 3G |
| Vibration rating                             | Complies with ANSI C136.31, 3G |
| <b>Initial Performance (IEC Compliant)</b>   |                                |
| Init. Corr. Colour Temperature               | 5500 K                         |
| Initial input power                          | 15 W                           |
| <b>Over Time Performance (IEC Compliant)</b> |                                |
| Lumen Maintenance 50% at 25 °C Reported      | 60000                          |
| Lumen Maintenance 50% at 50 °C Reported      | 60000                          |
| Lumen Maintenance 70% at 25 °C Reported      | 60000                          |
| Lumen Maintenance 70% at 50 °C Reported      | 60000                          |
| <b>Application Conditions</b>                |                                |
| Ambient temperature range                    | -40 to +50 °C                  |

|                                   |  |
|-----------------------------------|--|
| <b>Product Data</b>               |  |
| Full product code                 | 871829161105999  |
| Order product name                | BCS427 9/5500 L305   |
| EAN/UPC – product                 | 8718291611059  |
| Order code                        | 523-000081-02  |
| SAP numerator – quantity per pack | 1  |
| Numerator – packs per outer box   | 4  |
| SAP material                      | 910503703749   |
| SAP net weight (piece)            | 0.345 kg   |
| Commercial Code                   | 523-000081-02  |
| Catalogue number description      | eW Graze QLX Powercore, 5500 K, 9° x 9°<br>Beam Angle, 305 mm (1 ft) |



## Dimensional drawing

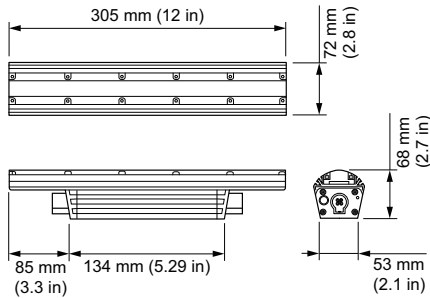

BCS427 9/5500 L305

