



# eW Graze QLX Powercore

**eW Graze QLX Powercore, 2700 K, 10° x 60° Beam Angle, 305 mm (1 ft)**

eW Graze QLX Powercore, 2700 K, 10° x 60° Beam Angle, 305 mm (1 ft)

Many architectural structures need a linear fixture capable of illuminating several storeys with minimal setback and reduced power consumption. Property owners/end users need a controllable product capable of dynamic illumination to draw attention to their establishments and emphasise their brands. Graze QLX Powercore is capable of illuminating over 10 metres at very close setback distances. Powercore technology enables simple installation and long product run lengths.

## Product data

General information		Operating and electrical	
Lamp family code	LED-HB [ LED High Brightness]	Input Voltage	100 to 277 V
Light source colour	Warm white	Input frequency	50 to 60 Hz
Light source replaceable	No	Controls and dimming	
Driver included	Yes	Dimmable	Yes
Optical cover/lens type	PCC [ Polycarbonate bowl/cover clear]	Mechanical and housing	
Luminaire light beam spread	10° x 60°	Housing material	Extruded aluminium
Protection class IEC	Safety class I	Optical cover/lens material	Polycarbonate
CE mark	CE mark	Length	305 mm
UL mark	UL and cUL mark	Colour	Aluminium
Lifetime to 70% luminous flux	100000 h		

## eW Graze QLX Powercore

### Approval and application

Ingress protection code	IP66 [ Dust penetration-protected, jet-proof]
Mech. impact protection code	IK10 [ 20 J vandal-resistant]
Vibration standard	Complies with ANSI C136.31, 3G
Vibration rating	Complies with ANSI C136.31, 3G

### Initial performance (IEC compliant)

Initial LED luminaire efficacy	60.5 lm/W
Init. Corr. Colour Temperature	2700 K
Initial input power	15 W

### Over time performance (IEC compliant)

Lumen Maintenance 50% at 25 °C Reported	60000
Lumen Maintenance 50% at 50 °C Reported	60000
Lumen Maintenance 70% at 25 °C Reported	60000
Lumen Maintenance 70% at 50 °C Reported	60000

### Application conditions

Ambient temperature range	-40 to +50 °C
---------------------------	---------------

### Product data

Full product code	871829161106699
Order product name	BCS427 10x60/2700 L305
EAN/UPC – product	8718291611066
Order code	523-000081-03
SAP numerator – quantity per pack	1
Numerator – packs per outer box	4
SAP material	910503703750
Net Weight (Piece)	1.200 kg
Commercial Code	523-000081-03
Catalogue number description	eW Graze QLX Powercore, 2700 K, 10° x 60° Beam Angle, 305 mm (1 ft)



## Dimensional drawing

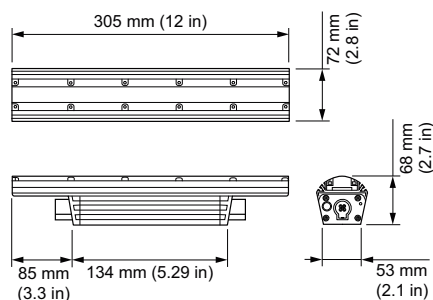

BCS427 10x60/2700 L305

