

**PHILIPS**

Lighting



# eColor Graze MX Powercore

**BCS439 9 RB L305**

Royal blue - 9° x 9° - 305 mm - Aluminium

Many architectural structures need a linear fixture capable of illuminating multiple storeys with minimal setback. Property owners/end users need a controllable product capable of dynamic illumination to draw attention to their establishments and emphasise their brands. Graze MX Powercore is capable of illuminating over 20 meters at very close setback distances. Powercore technology enables simple installation and long product run lengths.

## Product data

General Information		Input frequency	
Lamp family code	LED-HB [ LED High Brightness]	Input frequency	50 to 60 Hz
Lamp colour code	Royal blue	Controls and Dimming	
Light source replaceable	No	Dimmable	Yes
Driver included	Yes	Mechanical and Housing	
Optical cover/lens type	PCC [ Polycarbonate bowl/cover clear]	Housing material	Aluminum extruded
Luminaire light beam spread	9° x 9°	Optic material	Polycarbonate
Protection class IEC	Safety class I (I)	Optical cover/lens material	Polycarbonate
Glow-wire test	850/5 [ Temperature 850 °C, duration 5 s]	Length	305 mm
CE mark	CE mark	Colour	Aluminium
UL mark	UL mark	Approval and Application	
Lifetime to 70% luminous flux	100000 h	Ingress protection code	IP66 [ Dust penetration-protected, jet-proof]
FCC mark	FCC Class A	Mech. impact protection code	IK10 [ 20 J vandal-resistant]
Operating and Electrical			
Input voltage	100 to 277 V		

# eColor Graze MX Powercore

## Application Conditions

Ambient temperature range -20 to +50 °C

## Product Data

Full product code 871829160557799  
Order product name BCS439 9 RB L305  
EAN/UPC – product 8718291605577  
Order code 910503703994

Numerator – quantity per pack	1
Numerator – packs per outer box	4
Material no. (12NC)	910503703994
Net weight (piece)	1.200 kg

850°C

## Dimensional drawing

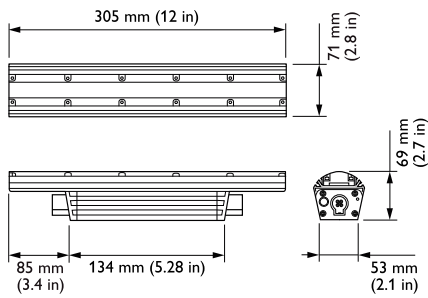

Graze

