



Smart Balance FFS, SpaceWise

FS484F LED125S/840 PSD-T SWZ ACL WH

SmartBalance FFS - LED module, system flux 12500 lm - Power supply unit with DALI touch-switch & dimming interface - Micro-lens optic - SpaceWise enabled

With Philips SpaceWise, customers can enjoy the very real benefits of controls – e.g. energy savings, visual comfort and personal control – without having to create a wired infrastructure.

Product data

General Information			
Number of light sources	1 pc	Separate switching	-
Lamp family code	LED125S [LED module, system flux 12500 lm]	Connection	Connection unit 3-pole
Light source color	840 neutral white	Cable	Cable 3.0 m with europlug connector 3-pole
Cap-Base	- [-]	Protection class IEC	Safety class I
Light source replaceable	No	Glow-wire test	Temperature 650 °C, duration 30 s
Number of gear units	2 units	Flammability mark	For mounting on normally flammable surfaces
Driver/power unit/transformer	Power supply unit with DALI touch-switch & dimming interface	CE mark	CE mark
Driver included	Yes	ENEC mark	ENEC plus mark
Optic type	-	Warranty period	5 years
Optical cover/lens type	Micro-lens optic	Remarks	*-Per Lighting Europe guidance paper "Evaluating performance of LED based luminaires - January 2018": statistically there is no relevant difference in lumen maintenance between B50 and for example B10. Therefore the median useful life (B50) value also represents the B10 value.
Luminaire light beam spread	114°		
Embedded control	SpaceWise enabled		
Control interface	DALI		

Smart Balance FFS, SpaceWise

Constant light output	No
Number of products on MCB of 16 A type B	10
RoHS mark	RoHS mark
Accessory PFC	N/A
Product family code	FS484F [SmartBalance FFS]
Unified glare rating CEN	13

Operating and Electrical

Input Voltage	220–240 V
Input Frequency	50 to 60 Hz
Control signal voltage	0–16 V DC DALI
Inrush current	50 A
Inrush time	2 ms
Power Factor (Min)	0.9

Controls and Dimming

Dimmable	Yes
----------	-----

Mechanical and Housing

Housing Material	Aluminum
Reflector material	Aluminum
Optic material	-
Optical cover/lens material	Acrylate and polycarbonate
Gear tray material	Steel
Fixation material	-
Optical cover/lens finish	Opal
Overall length	700 mm
Overall width	250 mm
Overall height	2000 mm
Color	White

Approval and Application

Ingress protection code	IP40 [Wire-protected]
Mech. impact protection code	IK02 [0.2 J standard]

Initial Performance (IEC Compliant)

Initial luminous flux (system flux)	12500 lm
Luminous flux tolerance	+/-10%
Initial LED luminaire efficacy	137 lm/W
Init. Corr. Color Temperature	4000 K
Init. Color Rendering Index	≥80
Initial chromaticity	(0.43, 0.40) SDCM <3
Initial input power	91 W
Power consumption tolerance	+/-10%

Over Time Performance (IEC Compliant)

Control gear failure rate at median useful life 50000 h	5 %
Lumen maintenance at median useful life* 50000 h	L85

Application Conditions

Ambient temperature range	+10 to +40 °C
Performance ambient temperature Tq	25 °C
Maximum dim level	1%
Suitable for random switching	Yes

Product Data

Full product code	871794311084100
Order product name	FS484F LED125S/840 PSD-T SWZ ACL WH
EAN/UPC - Product	8717943110841
Order code	910504095003
Numerator - Quantity Per Pack	1
Numerator - Packs per outer box	1
Material Nr. (12NC)	910504095003
Net Weight (Piece)	16.900 kg

Dimensional drawing

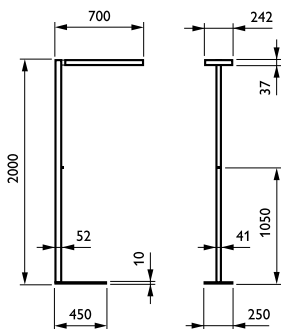

SmartBalance FS484F

Photometric data

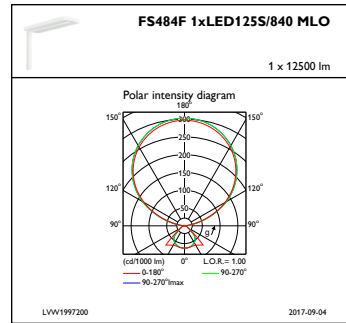
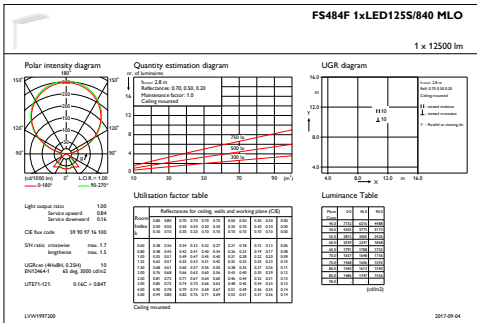

IFGU1_FS484F1xLED125S840MLO

IFPC1_FS484F1xLED125S840MLO

