



SmartBright Highbay G2

BY228P LED180/NW PSU

SmartBright Highbay G2 is a high efficient and reliable LED luminaire. Designed as the point to point replacement for HPI 250W/400W luminaires, it offers customers all the benefits of LED lighting – reduced energy consumption, longer service time and less maintenance. In addition, with using high quality of the optical plate, it provides an excellent quality of light, which effectively improves the comfort of your environment.

Product data

| General Information | |
|-------------------------------|--|
| Lamp colour code | 840 neutral white |
| Light source replaceable | No |
| Number of gear units | 2 units |
| Driver/power unit/transformer | PSU [Power supply unit] |
| Driver included | Yes |
| Optic type | WB [Wide beam] |
| Optical cover/lens type | O [Opal] |
| Luminaire light beam spread | 110° |
| Connection | Flying leads/wires |
| Cable | Cable 0.3 m without plug |
| Protection class IEC | Safety class I (I) |
| Glow-wire test | 650/5 [Temperature 650 °C, duration 5 s] |
| Flammability mark | F [For mounting on normally flammable surfaces] |
| CE mark | CE mark |
| ENEC mark | - |
| Warranty period | 3 years |
| Constant light output | No |
| Number of products on MCB | 5 |

| RoHS mark | - |
|-----------------------------|---------------|
| Operating and Electrical | |
| Input voltage | 220-240 V |
| Input frequency | 50 or 60 Hz |
| Inrush current | 65 A |
| Inrush time | 390 ms |
| Power factor (min.) | 0.95 |
| Controls and Dimming | |
| Dimmable | No |
| Mechanical and Housing | |
| Housing material | Aluminium |
| Reflector material | - |
| Optic material | Polycarbonate |
| Optical cover/lens material | Polycarbonate |
| Fixation material | - |
| Optical cover/lens finish | Frosted |

SmartBright Highbay G2

| | |
|------------------|---------------|
| Overall height | 122 mm |
| Overall diameter | 342 mm |
| Colour | Grey and Grey |

Approval and Application

| | |
|------------------------------|--------------------------|
| Ingress protection code | IP20 [Finger-protected] |
| Mech. impact protection code | IK03 [0.3 J] |

Initial Performance (IEC Compliant)

| | |
|--------------------------------|----------|
| Initial luminous flux | 18000 lm |
| Luminous flux tolerance | +/-10% |
| Initial LED luminaire efficacy | 90 lm/W |
| Lamp colour temperature | 4000 K |
| Colour Rendering Index | ≥80 |
| Initial chromaticity | SDCM<5 |
| Initial input power | 200 W |
| Power consumption tolerance | +/-10% |

Over Time Performance (IEC Compliant)

| | |
|---------------------------|---------|
| Median useful life L70B50 | 30000 h |
|---------------------------|---------|

| | |
|---------------------------|---------|
| Median useful life L80B50 | 25000 h |
| Median useful life L90B50 | 15000 h |

Application Conditions

| | |
|-------------------------------|---------------|
| Ambient temperature range | -20 to +40 °C |
| Suitable for random switching | No |

Product Data

| | |
|---------------------------------|----------------------|
| Full product code | 911401596731 |
| Order product name | BY228P LED180/NW PSU |
| Order code | 911401596731 |
| Numerator – quantity per pack | 1 |
| Numerator – packs per outer box | 1 |
| Material no. (12NC) | 911401596731 |
| Net weight (piece) | 2.599 kg |

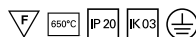

Dimensional drawing

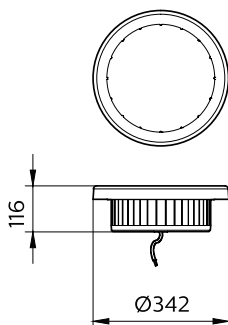

BY228P/BY238P/BY239P SmartBright Highbay

