



# Smart Post-top G3

BGP161 LED2300/WW PSU 220-240V 7043 IN

Smart Post Top G3 inherits the classic look and style of the previous generation with improved system efficacy and light quality.;The Smart Post Top G3 optimized optical design increases both horizontal and vertical uniformity. The highly efficient thermal system design ensures maximum heat transfer and longer LED service life.;This reliable luminaire system operates well in both low and high temperature environments. It offers more than 11 years expected life, reducing maintenance frequency and cost (based on a 50,000 hour rated life and 12 hours operation per day);It provides a comfortable and safe atmosphere to gardens, residential areas, courtyards, side streets, squares, parks & playgrounds.

## Product data

| General Information           |  | ENEC mark                                |              |
|-------------------------------|--|--|--------------|
| Lamp family code              | -  | Warranty period                          | 3 years      |
| Light source color            | Warm white   | Optic type outdoor                       | Symmetrical  |
| Light source replaceable      | Yes  | Constant light output                    | No           |
| Number of gear units          | 1 unit   | Number of products on MCB of 16 A type B | -            |
| Driver/power unit/transformer | PSU [ Power supply unit]                           | RoHS mark                                | RoHS mark    |
| Driver included               | Yes  | Light source engine type                 | LED          |
| Optical cover/lens type       | Acrylate cover and semi-matt high-reflective optic | <b>Light Technical</b>                   |              |
| Luminaire light beam spread   | -  | Upward light output ratio                | 0            |
| Control interface             | -  | Standard tilt angle posttop              | -            |
| Connection                    | Flying leads/wires                                 | Standard tilt angle side entry           | -            |
| Cable                         | Cable 450 mm without plug                          | <b>Operating and Electrical</b>          |              |
| Protection class IEC          | Safety class I (I)                                 | Input Voltage                            | 220 to 240 V |
| Flammability mark             | NO [ - ]   | Input Frequency                          | 50 to 60 Hz  |
| CE mark                       | -  |  |              |

## Smart Post-top G3

|                    |         |
|--------------------|---------|
| Inrush current     | 2.1 A   |
| Inrush time        | 22.3 ms |
| Power Factor (Min) | 0.9     |

### Controls and Dimming

|          |    |
|----------|----|
| Dimmable | No |
|----------|----|

### Mechanical and Housing

|                             |                                    |
|-----------------------------|------------------------------------|
| Housing Material            | Aluminum die-cast                  |
| Reflector material          | Acrylate                           |
| Optic material              | Acrylate                           |
| Optical cover/lens material | Acrylate                           |
| Fixation material           | Stainless steel                    |
| Mounting device             | 60P [ Post-top for diameter 60 mm] |
| Optical cover/lens shape    | Flat                               |
| Optical cover/lens finish   | Frosted                            |
| Overall height              | 265 mm                             |
| Overall diameter            | 578 mm                             |
| Color                       | Dark gray                          |

### Approval and Application

|  |   |
|--|---|
| Ingress protection code                | IP65 [ Dust penetration-protected, jet-proof] |
| Mech. impact protection code           | IK07 [ 2 J reinforced]                        |
| Surge Protection (Common/Differential) | 4/2 kV  |

### Initial Performance (IEC Compliant)

|                                     |                        |
|-------------------------------------|------------------------|
| Initial luminous flux (system flux) | 2300 lm                |
| Luminous flux tolerance             | +/-10%                 |
| Initial LED luminaire efficacy      | 85.18518518518519 lm/W |
| Init. Corr. Color Temperature       | 3000 K                 |
| Init. Color Rendering Index         | 70                     |
| Initial chromaticity                | SDCM>5                 |
| Initial input power                 | 27 W                   |
| Power consumption tolerance         | +/-10%                 |

### Application Conditions

|                           |                |
|---------------------------|----------------|
| Ambient temperature range | -40 to +50 °C  |
| Maximum dim level         | Not applicable |

### Product Data

|                                 |   |
|---------------------------------|---|
| Full product code               | 911401633903                              |
| Order product name              | BGP161 LED2300/WW PSU 220-240V 7043<br>IN |
| Order code                      | 911401633903                              |
| Numerator - Quantity Per Pack   | 1   |
| Numerator - Packs per outer box | 2   |
| Material Nr. (12NC)             | 911401633903                              |
| Net Weight (Piece)              | 4.499 kg                                  |

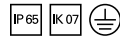

## Dimensional drawing

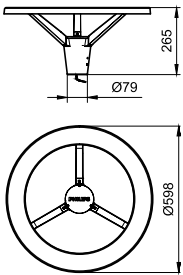

Smart Post-top G3

## Smart Post-top G3

