



SmartBright LED Floodlight

BVP173 LED66/NW 70W WB GREY SAA KC

SmartBright LED Floodlight, 6650 lm, 70 W, 740 neutral white, 30° x 80°, Safety class I, Mounting bracket adjustable

The SmartBright LED Floodlight is a versatile floodlight engineered to deliver significant energy savings, an ideal solution for diverse floodlighting applications. The product is also designed to meet relevant performance and safety standards, offering you reliable and long-lasting performance.

Product data

General Information		Luminaire light beam spread		30° x 80°
Lamp family code	LED66 [LED module 6600 lm]	Operating and Electrical		
Light source replaceable	No	Input Voltage	220 to 240 V	
Driver included	Yes	Line Frequency	50 or 60 Hz	
Light source engine type	LED	Inrush current	9.2 A	
Lighting Technology	LED	Inrush time	0.066 ms	
Flammability mark	For mounting on normally flammable surfaces	Power Consumption	70 W	
CE mark	CE mark	Power Factor (Fraction)	0.9	
Light Technical		Connection	Flying leads/wires	
Luminous Flux	6,650 lm	Cable	Cable 0.6 m without plug	
Correlated Color Temperature (Nom)	4000 K	Number of products on MCB of 16 A type B		37
Luminous Efficacy (rated) (Nom)	95 lm/W	Temperature		
Color rendering index (CRI)	>70	Ambient temperature range	-40 to +45 °C	
Light source color	740 neutral white			
Optical cover type	Polycarbonate bowl/cover UV-resistant			

SmartBright LED Floodlight

Controls and Dimming	
Dimmable	No
Control interface	-
Constant light output	No
Mechanical and Housing	
Housing Material	Aluminum die cast
Optical cover material	Polycarbonate
Housing Color	Grey
Mounting device	Mounting bracket adjustable
Optical cover shape	Flat
Optical cover finish	Frosted
Overall length	300 mm
Overall width	190 mm
Overall height	40 mm
Effective projected area	0.0795 m²
Dimensions (Height x Width x Depth)	40 x 190 x 300 mm
Approval and Application	
Ingress protection code	IP65 [Dust penetration-protected, jet-proof]
Mech. impact protection code	IK07 [2 J reinforced]
Protection class IEC	Safety class I

Initial Performance (IEC Compliant)	
Luminous flux tolerance	+/-10%
Initial chromaticity	SDCM<7
Power consumption tolerance	+/-10%
Application Conditions	
Maximum dim level	Not applicable
Product Data	
Order product name	BVP173 LED66/NW 70W WB GREY SAA KC
Full product name	BVP173 LED66/NW 70W WB GREY SAA KC
Full product code	871016332091599
Order code	911401689304
Material Nr. (12NC)	911401689304
Numerator - Quantity Per Pack	1
EAN/UPC - Product/Case	8710163320915
Numerator - Packs per outer box	8
EAN/UPC - Case	8710163321516

Dimensional drawing

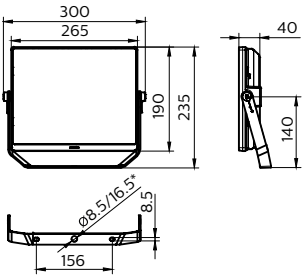

*Configuration for Australia,
New Zealand and Korea

