



Greenspace Flex

RS378B MR16 D102 R-R FX D

Accessory, Greenspace Flex

GreenSpace Flex is performance portfolio dedicated to Hospitality segment for GC/GM countries. With modular design concept, the light engines and different trims could have multiply of combination to satisfy diversified customer's requirement.

Product data

General Information		Operating and Electrical	
Number of gear units	1 unit	Input Voltage	220 to 240 V
Driver included	No	Line Frequency	50 or 60 Hz
Light source engine type	-	Power Consumption	10 W
Accessory color	Dark gray	Power Factor (Fraction)	0.9
CE mark	-	Connection	External connector
Warranty period	3 years	Cable	-
Flammability mark	-	Number of products on MCB of 16 A type B	-
ENEC mark	-		
Glow-wire test	Temperature 600 °C, duration 30 s	Temperature	
EU RoHS compliant	Yes	Ambient temperature range	-20 to +45 °C
Light Technical		Controls and Dimming	
Correlated Color Temperature (Nom)	-	Dimmable	No
Color rendering index (CRI)	>90	Driver/power unit/transformer	Electronic transformer
Beam angle of light source	- degree(s)	Control interface	-
Light source color	-	Constant light output	No
Optic type	-		
Optical cover type	-	Mechanical and Housing	
Luminaire light beam spread	-	Housing Material	Aluminum Alloy
		Reflector material	-

Greenspace Flex

Optic material	Polymethyl methacrylate
Optical cover material	-
Fixation material	Aluminum
Housing Color	Dark gray
Optical cover finish	-
Overall length	0 mm
Overall width	0 mm
Overall height	114 mm
Overall diameter	115 mm
Dimensions (Height x Width x Depth)	114 x 0 x 0 mm
Material	Aluminum

Approval and Application

Ingress protection code	IP20 [Finger-protected]
Mech. impact protection code	IK04 [0.5 J standard plus]
Protection class IEC	Safety class II

Initial Performance (IEC Compliant)

Luminous flux tolerance	+/-10%
-------------------------	--------

Power consumption tolerance	+/-10%
-----------------------------	--------

Over Time Performance (IEC Compliant)

Median useful life L80B50	50,000 hour(s)
---------------------------	----------------

Application Conditions

Maximum dim level	Not applicable
Suitable for random switching	No

Product Data

Order product name	RS378B MR16 D102 R-R FX D
Full product name	RS378B MR16 D102 R-R FX D
Full product code	911401720882
Order code	911401720882
Material Nr. (12NC)	911401720882
Numerator - Quantity Per Pack	1
Numerator - Packs per outer box	24

Dimensional drawing

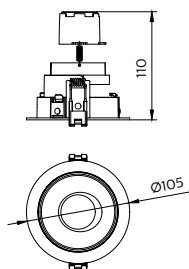

Cut out: Ø92

