



# Greenspace Flex

## RS378B P33 940 PSU-E NB M87

Greenspace Flex, 33 W, 940 neutral white, Finger-protected

GreenSpace Flex is performance portfolio dedicated to Hospitality segment for GC/GM countries. With modular design concept, the light engines and different trims could have multiply of combination to satisfy diversified customer's requirement.

### Product data

General Information	
Number of gear units	1 unit
Driver included	Yes
Light source engine type	LED
CE mark	-
Warranty period	3 years
Glow-wire test	Temperature 600 °C, duration 30 s
EU RoHS compliant	Yes
Light Technical	
Luminous Flux	2,970 lm
Correlated Color Temperature (Nom)	4000 K
Luminous Efficacy (rated) (Nom)	90 lm/W
Color rendering index (CRI)	>90
Light source color	940 neutral white
Optical cover type	-
Operating and Electrical	
Input Voltage	220 to 240 V
Line Frequency	50 or 60 Hz
Average CLO power consumption	2635 W

Power Consumption	33 W
Power Factor (Fraction)	0.9
Connection	External connector
Cable	-
Number of products on MCB of 16 A type B	-
Temperature	
Ambient temperature range	-20 to +45 °C
Controls and Dimming	
Dimmable	No
Driver/power unit/transformer	Electronic transformer
Control interface	-
Constant light output	No
Mechanical and Housing	
Housing Material	Aluminum Alloy
Optic material	Polymethyl methacrylate
Optical cover material	-
Fixation material	Aluminum
Housing Color	Dark gray

# Greenspace Flex

Optical cover finish	-
Overall height	107 mm
Overall diameter	87 mm

## Approval and Application

Ingress protection code	IP20 [Finger-protected]
Mech. impact protection code	IK04 [0.5 J standard plus]
Protection class IEC	Safety class II

## Initial Performance (IEC Compliant)

Luminous flux tolerance	+/-10%
Initial chromaticity	SDCM<3
Power consumption tolerance	+/-10%

## Over Time Performance (IEC Compliant)

Median useful life L80B50	50,000 hour(s)
---------------------------	----------------

Application Conditions	
Maximum dim level	Not applicable
Suitable for random switching	No

## Product Data

Order product name	RS378B P33 940 PSU-E NB M87
Full product name	RS378B P33 940 PSU-E NB M87
Full product code	692382865029299
Order code	911401721542
Material Nr. (12NC)	911401721542
Numerator - Quantity Per Pack	1
EAN/UPC - Product/Case	6923828650292
Numerator - Packs per outer box	18
EAN/UPC - Case	6923828652708

## Dimensional drawing

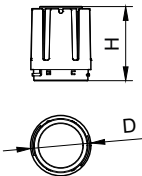
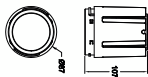

Modular Type	D, mm	H, mm
RS378B P6/P11 M55	55	49
RS378B P15 M55	55	49
RS378B P24 M70	70	90
RS378B P33 M87	87	107
RS378B P42 M102	102	116

