



# Greenspace Flex

## RS378B P33 930 PSU-E MB M87

Greenspace Flex, 33 W, 930 warm white, 24°, Finger-protected

GreenSpace Flex is performance portfolio dedicated to Hospitality segment for GC/GM countries. With modular design concept, the light engines and different trims could have multiply of combination to satisfy diversified customer's requirement.

### Product data

| General Information                |                                   |
|------------------------------------|-----------------------------------|
| Number of gear units               | 1 unit                            |
| Driver included                    | Yes                               |
| Light source engine type           | LED                               |
| CE mark                            | -                                 |
| Warranty period                    | 3 years                           |
| Glow-wire test                     | Temperature 600 °C, duration 30 s |
| EU RoHS compliant                  | Yes                               |
| Light Technical                    |                                   |
| Luminous Flux                      | 2,739 lm                          |
| Correlated Color Temperature (Nom) | 3000 K                            |
| Luminous Efficacy (rated) (Nom)    | 83 lm/W                           |
| Color rendering index (CRI)        | >90                               |
| Light source color                 | 930 warm white                    |
| Optical cover type                 | -                                 |
| Luminaire light beam spread        | 24°                               |
| Operating and Electrical           |                                   |
| Input Voltage                      | 220 to 240 V                      |
| Line Frequency                     | 50 or 60 Hz                       |

| Average CLO power consumption            | 2400 W                  |
|--|-------------------------|
| Power Consumption                        | 33 W                    |
| Power Factor (Fraction)                  | 0.9                     |
| Connection                               | External connector      |
| Cable                                    | -                       |
| Number of products on MCB of 16 A type B | -                       |
| Temperature                              |                         |
| Ambient temperature range                | -20 to +45 °C           |
| Controls and Dimming                     |                         |
| Dimmable                                 | No                      |
| Driver/power unit/transformer            | Electronic transformer  |
| Control interface                        | -                       |
| Constant light output                    | No                      |
| Mechanical and Housing                   |                         |
| Housing Material                         | Aluminum Alloy          |
| Optic material                           | Polymethyl methacrylate |
| Optical cover material                   | -                       |
| Fixation material                        | Aluminum                |

Greenspace Flex

|                      |           |
|----------------------|-----------|
| Housing Color        | Dark gray |
| Optical cover finish | -         |
| Overall height       | 107 mm    |
| Overall diameter     | 87 mm     |

Approval and Application

|                              |                            |
|------------------------------|----------------------------|
| Ingress protection code      | IP20 [Finger-protected]    |
| Mech. impact protection code | IK04 [0.5 J standard plus] |
| Protection class IEC         | Safety class II            |

Initial Performance (IEC Compliant)

|                             |        |
|-----------------------------|--------|
| Luminous flux tolerance     | +/-10% |
| Initial chromaticity        | SDCM<3 |
| Power consumption tolerance | +/-10% |

Over Time Performance (IEC Compliant)

|                           |                |
|---------------------------|----------------|
| Median useful life L80B50 | 50,000 hour(s) |
|---------------------------|----------------|

|                               |                |
|-------------------------------|----------------|
| Application Conditions        |                |
| Maximum dim level             | Not applicable |
| Suitable for random switching | No             |

Product Data

|                                 |                             |
|---------------------------------|-----------------------------|
| Order product name              | RS378B P33 930 PSU-E MB M87 |
| Full product name               | RS378B P33 930 PSU-E MB M87 |
| Full product code               | 692382865027899             |
| Order code                      | 911401721562                |
| Material Nr. (12NC)             | 911401721562                |
| Numerator - Quantity Per Pack   | 1                           |
| EAN/UPC - Product/Case          | 6923828650278               |
| Numerator - Packs per outer box | 18                          |
| EAN/UPC - Case                  | 6923828652685               |

Dimensional drawing

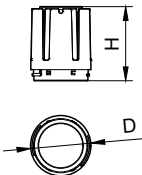
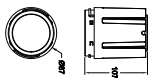

| Modular Type      | D, mm | H, mm |
|-------------------|-------|-------|
| RS378B P6/P11 M55 | 55    | 49    |
| RS378B P15 M55    | 55    | 49    |
| RS378B P24 M70    | 70    | 90    |
| RS378B P33 M87    | 87    | 107   |
| RS378B P42 M102   | 102   | 116   |

