



Greenspace Flex

RS378B P42 940 PSU-E WB M102

Greenspace Flex, 42 W, 940 neutral white, 32°, Finger-protected

GreenSpace Flex is performance portfolio dedicated to Hospitality segment for GC/GM countries. With modular design concept, the light engines and different trims could have multiply of combination to satisfy diversified customer's requirement.

Product data

General Information		Luminaire light beam spread	
Number of gear units	1 unit	32°	
Driver included	Yes	Operating and Electrical	
Light source engine type	LED	Input Voltage	220 to 240 V
CE mark	-	Line Frequency	50 or 60 Hz
Warranty period	3 years	Average CLO power consumption	3515 W
Flammability mark	-	Power Consumption	42 W
ENEC mark	-	Power Factor (Fraction)	0.9
Glow-wire test	Temperature 600 °C, duration 30 s	Connection	External connector
EU RoHS compliant	Yes	Cable	-
Light Technical		Number of products on MCB of 16 A type B	-
Luminous Flux	4,242 lm	Temperature	
Correlated Color Temperature (Nom)	4000 K	Ambient temperature range	-20 to +45 °C
Luminous Efficacy (rated) (Nom)	101 lm/W	Controls and Dimming	
Color rendering index (CRI)	>90	Dimmable	No
Beam angle of light source	- degree(s)	Driver/power unit/transformer	Electronic transformer
Light source color	940 neutral white	Control interface	-
Optic type	-	Constant light output	No
Optical cover type	-		

Greenspace Flex

Mechanical and Housing	
Housing Material	Aluminum Alloy
Reflector material	-
Optic material	Polymethyl methacrylate
Optical cover material	-
Fixation material	Aluminum
Housing Color	Dark gray
Optical cover finish	-
Overall height	116 mm
Overall diameter	102 mm

Approval and Application	
Ingress protection code	IP20 [Finger-protected]
Mech. impact protection code	IK04 [0.5 J standard plus]
Protection class IEC	Safety class II

Initial Performance (IEC Compliant)	
Luminous flux tolerance	+/-10%
Initial chromaticity	SDCM<3

Power consumption tolerance	+/-10%
-----------------------------	--------

Over Time Performance (IEC Compliant)	
Median useful life L80B50	50,000 hour(s)

Application Conditions	
Maximum dim level	Not applicable
Suitable for random switching	No

Product Data	
Order product name	RS378B P42 940 PSU-E WB M102
Full product name	RS378B P42 940 PSU-E WB M102
Full product code	911401721692
Order code	911401721692
Material Nr. (12NC)	911401721692
Numerator - Quantity Per Pack	1
Numerator - Packs per outer box	12

Dimensional drawing

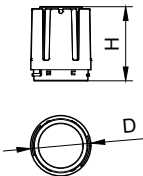
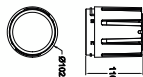

Modular Type	D, mm	H, mm
RS378B P6/P11 M55	55	49
RS378B P15 M55	55	49
RS378B P24 M70	70	90
RS378B P33 M87	87	107
RS378B P42 M102	102	116

