



# Greenperform Waterproof G2 - WT188C

## WT188C LED40 CW L1200 PSU MW

Greenperform Waterproof G2 - WT188C, 34 W, 4000 lm, 6500 K, 120°

Greenperform Waterproof G2 luminaire and its components are designed for both indoor and semi-outdoor application (anti-UV PC material housing and diffuser, stainless steel installation accessory). We design for friendly optical, energy saving, reliable quality, and easy wiring. Beyond that, GreenParking wireless motion detective system is ready to provide the maximum energy saving and new lighting experience to you.

### Product data

| General Information      |                                  | Light Technical                    |                                |
|--------------------------|----------------------------------|------------------------------------|--------------------------------|
| Light source replaceable | No                               | Luminous Flux                      | 4,000 lm                       |
| Number of gear units     | 1 unit                           | Correlated Color Temperature (Nom) | 6500 K                         |
| Driver included          | Yes                              | Luminous Efficacy (rated) (Nom)    | 117 lm/W                       |
| Light source engine type | LED                              | Color rendering index (CRI)        | >80                            |
| CE mark                  | CE mark                          | Beam angle of light source         | - degree(s)                    |
| Warranty period          | 3 years                          | Light source color                 | Cool white                     |
| Flammability mark        | -                                | Optic type                         | Symmetrical                    |
| ENEC mark                | -                                | Optical cover type                 | Polycarbonate bowl/cover foggy |
| Glow-wire test           | Temperature 750 °C, duration 5 s | Luminaire light beam spread        | 120°                           |
| EU RoHS compliant        | Yes                              |                                    |                                |

# Greenperform Waterproof G2 - WT188C

| Operating and Electrical                 |                          |
|--|--------------------------|
| Input Voltage                            | 220 to 240 V             |
| Line Frequency                           | 50 to 60 Hz              |
| Inrush current                           | 12 A                     |
| Inrush time                              | 0.59 ms                  |
| Power Consumption                        | 34 W                     |
| Power Factor (Fraction)                  | 0.9                      |
| Connection                               | Flying leads/wires       |
| Cable                                    | Cable 0.2 m without plug |
| Number of products on MCB of 16 A type B | 24                       |

| Temperature               |               |
|---------------------------|---------------|
| Ambient temperature range | -30 to +45 °C |

| Controls and Dimming          |                            |
|-------------------------------|----------------------------|
| Dimmable                      | No                         |
| Driver/power unit/transformer | Power supply unit (On/Off) |
| Control interface             | -                          |
| Constant light output         | No                         |

| Mechanical and Housing |                 |
|------------------------|-----------------|
| Housing Material       | Polycarbonate   |
| Reflector material     | Steel           |
| Optic material         | Polycarbonate   |
| Optical cover material | Polycarbonate   |
| Fixation material      | Stainless steel |
| Housing Color          | Gray and white  |
| Optical cover finish   | Opal            |
| Overall length         | 1,177 mm        |
| Overall width          | 84 mm           |
| Overall height         | 83 mm           |

|                                     |                   |
|-------------------------------------|-------------------|
| Dimensions (Height x Width x Depth) | 83 x 84 x 1177 mm |
|-------------------------------------|-------------------|

| Approval and Application     |  |
|------------------------------|--|
| Ingress protection code      | IP65 [Dust penetration-protected, jet-proof] |
| Mech. impact protection code | IK08 [5 J vandal-protected]                  |
| Protection class IEC         | Safety class I                               |

| Initial Performance (IEC Compliant) |        |
|-------------------------------------|--------|
| Luminous flux tolerance             | +/-10% |
| Initial chromaticity                | SDCM<5 |
| Power consumption tolerance         | +/-10% |

| Over Time Performance (IEC Compliant) |                |
|---------------------------------------|----------------|
| Median useful life L70B50             | 50,000 hour(s) |
| Median useful life L80B50             | 45,000 hour(s) |
| Median useful life L90B50             | 35,000 hour(s) |

| Application Conditions |                |
|------------------------|----------------|
| Maximum dim level      | Not applicable |

| Product Data                    |                              |
|---------------------------------|------------------------------|
| Order product name              | WT188C LED40 CW L1200 PSU MW |
| Full product name               | WT188C LED40 CW L1200 PSU MW |
| Full product code               | 911401832497                 |
| Order code                      | 911401832497                 |
| Material Nr. (12NC)             | 911401832497                 |
| Numerator - Quantity Per Pack   | 1                            |
| Numerator - Packs per outer box | 1                            |

## Dimensional drawing

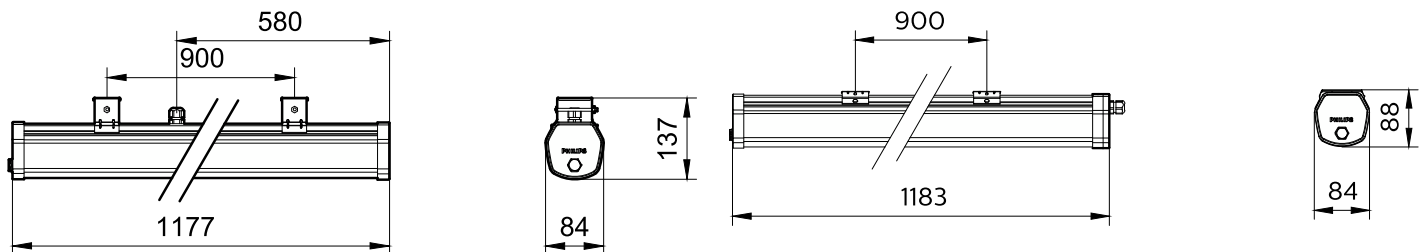

## Greenperform Waterproof G2 - WT188C

