



Essential SmartBright G2 LED Floodlight

BVP133 LED24/WW 30W 220-240V WB

Essential SmartBright G2 LED floodlight comes with a compact and sturdy design. It is light weight with die-cast aluminium housing and corrosion-proof powder coating, suitable for general outdoor application. High efficiency designed with latest LED technology, achieves substantial energy savings comparing to conventional floodlights.

Product data

General Information	
Lamp colour code	830 warm white
Light source replaceable	No
Driver included	Yes
Optical cover/lens type	Polycarbonate bowl/cover flat
Luminaire light beam spread	100°
Control interface	-
Connection	Flying leads/wires
Protection class IEC	Safety class I
Flammability mark	-
CE mark	CE mark
LED engine type	LED
Light Technical	
Standard tilt angle post-top	-
Standard tilt angle side entry	-
Operating and Electrical	
Input voltage	220 to 240 V
Input frequency	50 to 60 Hz

Power factor (min.)	0.9
Controls and Dimming	
Dimmable	No
Mechanical and Housing	
Housing material	Aluminium die-cast
Optical cover/lens material	Polycarbonate
Mounting device	Mounting bracket adjustable
Optical cover/lens finish	Textured
Overall length	170 mm
Overall width	146 mm
Overall height	36 mm
Approval and Application	
Ingress protection code	IP65 [Dust penetration-protected, jet-proof]
Mech. impact protection code	IK06 [1 J]
Initial Performance (IEC Compliant)	
Initial luminous flux	2400 lm

Essential SmartBright G2 LED Floodlight

Luminous flux tolerance	+/-10%
Initial LED luminaire efficacy	80.00 lm/W
Lamp colour temperature	3000 K
Colour Rendering Index	>80
Initial chromaticity	SDCM <7
Initial input power	30 W
Power consumption tolerance	+/-10%

Order product name	BVP133 LED24/WW 30W 220-240V WB
EAN/UPC – product	8710163314365
Order code	911401859398
Numerator – quantity per pack	1
Numerator – packs per outer box	12
Material no. (12NC)	911401859398
Net weight (piece)	0.650 kg

Product Data

Full product code	911401859398
-------------------	--------------

Dimensional drawing

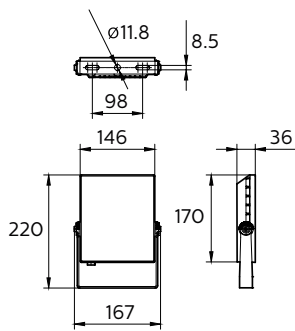

BVP131/132/133/135 LED WB

