



Quebec LED

BRP776 LED30-4S/830 PSR DM50 FR BK D11 5

QUEBEC LED - LED module 3000 lm - 4th generation, screw fixation - 830 warm white - Power supply unit regulating - Safety class I (I) - Distribution medium 50 - Flat glass - Black - Philips standard surge protection level kV - - - 25 °C - -

Quebec LED is a stylish luminaire designed to brighten up residential streets and pathways, precincts, parks and other urban spaces. It incorporates an energy-efficient LED engine with high-performance optics, while at the same time retaining the character of the original Quebec fixture. It also offers a choice of bowl versions and mounting options. All these factors together make Quebec LED a versatile solution that can meet the needs of any project.

Product data

General Information		Protection class IEC	Safety class I (I)
Lamp family code	LED30 [LED module 3000 lm]	Flammability mark	NO [-]
Lamp version	4S [4th generation, screw fixation]	CE mark	CE mark
Light source colour	830 warm white	ENEC mark	ENEC mark
Light source replaceable	Yes	Warranty period	5 years
Number of gear units	1 unit	Outdoor optic type	Distribution medium 50
Driver/power unit/transformer	PSR [Power supply unit regulating]	Remarks	*-Per Lighting Europe guidance paper "Evaluating performance of LED based luminaires - January 2018": statistically there is no relevant difference in lumen maintenance between B50 and for example B10. Therefore the median useful life (B50) value also represents the B10 value. * At extreme ambient temperatures the luminaire might
Driver included	Yes		
Optical cover/lens type	FG [Flat glass]		
Luminaire light beam spread	30° - 5° x 153°		
Control interface	Analog		
Connection	Plug-in connector 3-pole Wieland/Adels compatible and 2x 2-pole control signal for light regulation		
Cable	-		

Quebec LED

	automatically dim down to protect components
Constant light output	No
Number of products on MCB	20
RoHS mark	RoHS mark
LED engine type	LED
Product Family Code	BRP776 [QUEBEC LED]

Light Technical

Upward light output ratio	0.03
Standard tilt angle post-top	-
Standard tilt angle side entry	0°

Operating and Electrical

Input voltage	220 to 240 V
Input frequency	50 to 60 Hz
Inrush current	22 A
Inrush time	0.29 ms
Power factor (min.)	0.97
Power factor (nom.)	0.92

Controls and Dimming

Dimmable	Yes
----------	-----

Mechanical and Housing

Housing material	Aluminum
Reflector material	-
Optic material	Polymethyl methacrylate
Optical cover/lens material	Glass
Fixation material	Aluminum
Mounting device	No [-]
Optical cover/lens shape	Flat
Optical cover/lens finish	Frosted
Overall height	388 mm
Overall diameter	472 mm
Effective projected area	0.094 m ²
Colour	Black

Approval and Application

Ingress protection code	IP65 [Dust penetration-protected, jet-proof]
-------------------------	---

Mech. impact protection code	IK08 [5 J vandal-protected]
Surge protection (common/differential)	Philips standard surge protection level kV

Initial Performance (IEC Compliant)

Initial luminous flux	2520 lm
Luminous flux tolerance	+/-7%
Initial LED luminaire efficacy	107 lm/W
Init. Corr. colour temperature	3000 K
Init. colour rendering index	>80
Initial chromaticity	(0.410, 0.390) SDCM <5
Initial input power	23.5 W
Power consumption tolerance	+/-11%

Over Time Performance (IEC Compliant)

Control gear failure rate at median useful life 100000 h	10 %
Lumen maintenance at median useful life* 100000 h	94

Application Conditions

Ambient temperature range	-40 to +50 °C
Performance ambient temperature Tq	25 °C
Maximum dimming level	25%

Product Data

Full product code	871869908988700
Order product name	BRP776 LED30-4S/830 PSR DM50 FR BK D11 5
EAN/UPC – product	8718699089887
Order code	08988700
Numerator – quantity per pack	1
Numerator – packs per outer box	1
Material no. (12NC)	912300023478
Net weight (piece)	6.175 kg

Dimensional drawing

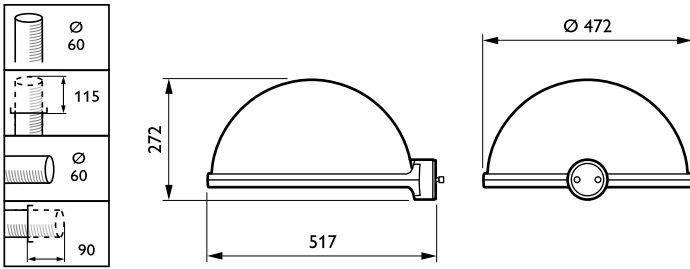

Quebec LED BRP775/776

Photometric data

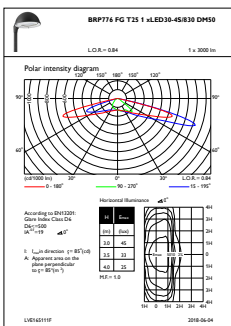

OFPL1_BRP776FGT251xLED30-4S830DM50

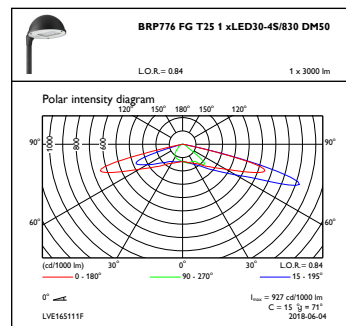

OFPC1_BRP776FGT251xLED30-4S830DM50

