



**eColor Blast Powercore gen4, Blue, 100 – 277 VAC,  
6°, Native (no spread lens), Black Housing**

eColor Blast Powercore gen4 high-performance LED luminaires provide a high-intensity wash of colour light with simplified installation. eColor Blast Powercore gen4 offers a range of accessories that allow for customisable beam angles for floodlighting, spotlighting, wall washing and grazing, along with the efficiency and cost-effectiveness of Powercore technology in a rugged die-cast aluminium housing.

General Information	
Light source colour	Blue
Light source replaceable	No
Driver included	Yes
Luminaire light beam spread	6°
CE mark	CE mark
UL mark	UL and cUL mark
Operating and Electrical	
Input Voltage	100 to 277 V
Input frequency	50 to 60 Hz
Power factor (min.)	0.85

Power factor (nom.)	0.9
<b>Controls and Dimming</b>	
Dimmable	Yes
<b>Mechanical and Housing</b>	
Housing material	Aluminium die-cast
Optic material	Glass
Optical cover/lens material	Glass
Optical cover/lens shape	Flat
Optical cover/lens finish	Clear
Effective projected area	0.068 m <sup>2</sup>

## eColor Blast Powercore gen4

Colour	Black
<b>Approval and Application</b>	
Ingress protection code	IP66 [ Dust penetration-protected, jet-proof]
Mech. impact protection code	IK10 [ 20 J vandal-resistant]
Vibration standard	Complies with ANSI C136.31, 3G
Vibration rating	Complies with ANSI C136.31, 3G
<b>Initial Performance (IEC Compliant)</b>	
Initial input power	50 W
<b>Application Conditions</b>	
Ambient temperature range	-40 to +50 °C
<b>Product Data</b>	
Full product code	871829138897599

Order product name	BCP482 36xLED-HB/BLUE 100-277V 6 BK
EAN/UPC – product	8718291388975
Order code	223-000093-09
SAP numerator – quantity per pack	1
Numerator – packs per outer box	2
SAP material	912400130364
SAP net weight (piece)	4.146 kg
Commercial Code	223-000093-09
Catalogue number description	eColor Blast Powercore gen4, Blue, 100 – 277 VAC, 6°, Native (no spread lens), Black Housing



### Dimensional drawing

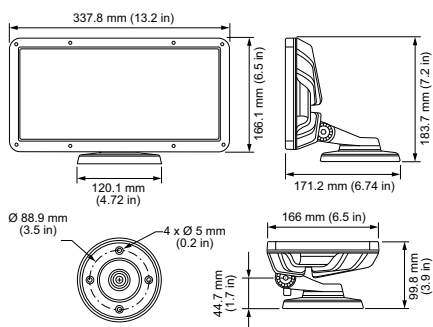

eColor Blast Powercore gen4

