



Vaya Flood LP Small

BCP431 RGB 100-240 20 CE CQC PSE

Medium beam angle 20°

With budgets under pressure, property owners and developers are looking, more than ever, for value for money when it comes to capital expenditures. Vaya Flood is an affordable and reliable LED solution that minimizes the initial investment, while providing exceptional flexibility to create eye-catching, dynamic and colorful lighting effects that can bring a property to life. The robust Vaya Flood offers a wide choice of mono colors with a simple on-off switch and changing colors with a standard DMX512 controller. It is also extremely easy to install and aim.

Product data

General Information		Controls and Dimming	
Lamp family code	LED-HB [LED High Brightness]	Dimmable	Yes
Light source colour	Red, green and blue (RGB)	Mechanical and Housing	
Light source replaceable	No	Housing material	Aluminum die-cast
Driver included	Yes	Optic material	Glass
Optical cover/lens type	GT [Tempered glass]	Optical cover/lens material	Tempered glass
Protection class IEC	Safety class I (I)	Optical cover/lens shape	Flat
CE mark	CE mark	Optical cover/lens finish	Clear
CQC mark	CQC-mark	Colour	Dark gray
Outdoor optic type	Medium beam angle 20°	Approval and Application	
PSE mark	PSE mark	Ingress protection code	IP66 [Dust penetration-protected, jet-proof]
Angle	20°	Mech. impact protection code	IK06 [1 J]
Operating and Electrical		Vibration standard	Complies with ANSI C136.31
Input voltage	100 to 240 V		Complies with ANSI C136.31
Input frequency	50 to 60 Hz		

Vaya Flood LP Small

Initial Performance (IEC Compliant)

Initial luminous flux	1344 lm
Initial LED luminaire efficacy	33.6 lm/W
Initial input power	45 W

Over Time Performance (IEC Compliant)

Lumen Maintenance 50% at 25°C Calculated	100000
Lumen Maintenance 50% at 25°C Reported	60000
Lumen Maintenance 50% at 40°C Calculated	100000
Lumen Maintenance 50% at 40°C Reported	60000
Lumen Maintenance 70% at 25°C Calculated	100000
Lumen Maintenance 70% at 25°C Reported	60000
Lumen Maintenance 70% at 40°C Calculated	100000
Lumen Maintenance 70% at 40°C Reported	60000

Application Conditions

Ambient temperature range	-40 to +40 °C
---------------------------	---------------

Product Data

Full product code	871829164707299
Order product name	BCP431 RGB 100-240 20 CE CQC PSE
EAN/UPC – product	8718291647072
Order code	64707299
Numerator – quantity per pack	1
Numerator – packs per outer box	4
Material no. (12NC)	912400133973
Net weight (piece)	2.800 kg



Dimensional drawing

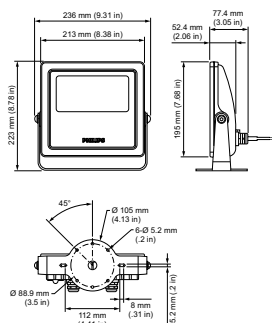

Vaya

