



eW Graze MX Powercore

eW Graze MX Powercore, 3000 K, 30° x 60° Beam Angle, 305 mm (1 ft)

eW Graze MX Powercore, 3000 K, 30° x 60° Beam Angle, 305 mm (1 ft)

eW Graze MX Powercore is a high-performance, exterior linear luminaire that features the most light output in our line of solid white light grazing luminaires. It is designed to highlight architectural features ranging from surface textures and molding details to archways and windows. Graze Essential White luminaires offer a single channel of white light. Available in 2700 K, 3000 K, 3500 K, 4000 K, and 5500 K. Multiple luminaire lengths, beam angles, output levels, and power consumption levels support a large range of façade or surface illumination applications. Low-profile housing, connectorized cabling, a universal power input range, and direct line voltage operation make Graze luminaires easy to install and operate.

Product data

General information		Lifetime to 70% luminous flux	
Lamp family code	LED-HB [LED High Brightness]	60000 h	
Light source color	White	Operating and electrical	
Light source replaceable	No	Input Voltage	100 to 277 V
Driver included	Yes	Input Frequency	50 to 60 Hz
Luminaire light beam spread	30° x 60°	Controls and dimming	
Protection class IEC	Safety class I	Dimmable	Yes
CE mark	CE mark		
UL mark	UL and cUL mark		
Lifetime to 50% luminous flux	60000 h		

eW Graze MX Powercore

Mechanical and housing

Housing Material	Aluminum extruded
Optical cover/lens material	Polycarbonate
Length	305 mm

Approval and application

Ingress protection code	IP66 [Dust penetration-protected, jet-proof]
Mech. impact protection code	IK10 [20 J vandal-resistant]
Vibration Standard	Complies with ANSI C136.31, 3G
Corrosion Resistance	Complies with ASTM B117 standard with special order. Please contact your Color Kinetics Lighting Sales rep for custom configurations.
Vibration Rating	Complies with ANSI C136.31, 3G

Initial performance (IEC compliant)

Init. Corr. Color Temperature	3000 K
Initial input power	15 W

Over time performance (IEC compliant)

Lumen Maintenance 50% at 25°C	60000
Reported	
Lumen Maintenance 50% at 50°C	60000
Reported	

Lumen Maintenance 70% at 25°C	60000
Reported	
Lumen Maintenance 70% at 50°C	60000
Reported	

Application conditions

Ambient temperature range	-20 to +50 °C
---------------------------	---------------

Product data

Full product code	871829139461799
Order product name	BCS419 30x60-3000 L305
EAN/UPC - Product	8718291394617
Order code	523-000080-63
Numerator - Quantity Per Pack	1
Numerator - Packs per outer box	4
Material Nr. (12NC)	912400135116
Net Weight (Piece)	1.200 kg
Catalog Number	523-000080-63
Catalog Number Description	eW Graze MX Powercore, 3000 K, 30° x 60° Beam Angle, 305 mm (1 ft)



Dimensional drawing

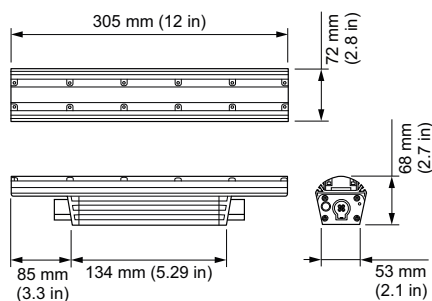

BCS419 30x60-3000 L305

