



# ColorGraze IntelliHue Powercore

**ColorGraze IntelliHue Powercore, 100 to 277 VAC, 15° x 30°, 305 mm (1 ft)**

ColorGraze IntelliHue Powercore, 100 to 277 VAC, 15° x 30°, 305 mm (1 ft)

Graze is a high-performance, exterior linear luminaire designed to highlight architectural features ranging from surface textures and moulding details to archways and windows. Graze IntelliHue utilises Color Kinetics IntelliHue technology to produce millions of saturated colours, pastels and high-quality white light, in the same precisely controllable luminaire. Multiple fixture lengths and beam angles support a large range of façade or surface illumination applications. Low-profile housing, connectorised cabling, a universal power input range and direct line voltage operation make Graze luminaires easy to install and operate.

## Product data

General information	
Lamp family code	LED-HB [ LED High Brightness]
Light source colour	IntelliHue
Light source replaceable	No
Driver included	Yes
Optical cover/lens type	PC-UV [ Polycarbonate bowl/cover UV-resistant]
CE mark	CE mark
UL mark	UL and cUL mark

Light technical	
Efficacy (lm/W) @ 4,000 K	45.5 lm/W
Efficacy (lm/W) @ 2,700 K	47.7 lm/W
CRI @ 4,000 K	81.9
CRI @ 2,700	87.7
Operating and electrical	
Input Voltage	100 to 277 V
Input frequency	50 to 60 Hz

ColorGraz e IntelliHue Powercore

Controls and dimming	
Dimmable	Yes
Mechanical and housing	
Housing material	Aluminum extruded
Optic material	Polycarbonate
Optical cover/lens material	Polycarbonate
Length	305 mm
Colour	Aluminum
Approval and application	
Ingress protection code	IP66 [ Dust penetration-protected, jet-proof]
Energy Efficiency Class	G
Mech. impact protection code	IK10 [ 20 J vandal-resistant]
Vibration standard	Complies with ANSI C136.31, 3G
FCC mark	FCC Class A
Vibration rating	Complies with ANSI C136.31, 3G
	887738
Initial performance (IEC compliant)	
Initial luminous flux (system flux)	687 lm
Initial luminous flux at colour temperature of 2,700 K	442 lm
Initial luminous flux at colour temperature of 4,000 K	534 lm
Initial LED luminaire efficacy	38.5 lm/W
Initial input power	18 W

Over time performance (IEC compliant)	
Lumen Maintenance 50% at 25 °C Reported	75000
Lumen Maintenance 50% at 50 °C Reported	70000
Lumen Maintenance 70% at 25 °C Calculated	100000
Lumen Maintenance 70% at 25 °C Reported	70000
Lumen Maintenance 70% at 50 °C Calculated	100000
Lumen Maintenance 70% at 50 °C Reported	65000
Application conditions	
Ambient temperature range	-40 to +50 °C
Product data	
Full product code	871869921247699
Order product name	BCS559 15x30 RGBMW L305
EAN/UPC – product	8718699212476
Order code	423-000016-02
SAP numerator – quantity per pack	1
Numerator – packs per outer box	4
SAP material	912400135877
Net Weight (Piece)	1.200 kg
Commercial Code	423-000016-02
Catalogue number description	ColorGraz e IntelliHue Powercore, 100 to 277 VAC, 15° x 30°, 305 mm (1 ft)



Dimensional drawing

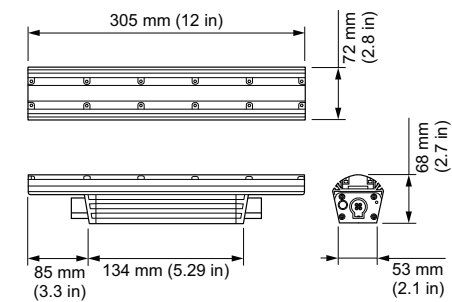

BCS559 15x30 RGBMW L305

