



ColorGraze IntelliHue Powercore

BCS559 30x60 RGBMW L305

LED High Brightness

Graze is a high-performance, exterior linear luminaire designed to highlight architectural features ranging from surface textures and molding details to archways and windows. Graze IntelliHue utilizes Philips Color Kinetics IntelliHue technology to produce millions of saturated colors, pastels, and high quality white light, in the same precisely controllable luminaire. Multiple fixture lengths, and beam angles support a large range of façade or surface illumination application. Low-profile housing, connectorized cabling, a universal power input range, and direct line voltage operation make Graze luminaires easy to install and operate.

Product data

General Information		Controls and Dimming	
Lamp family code	LED-HB [LED High Brightness]	Dimmable	Yes
Light source color	IntelliHue	Mechanical and Housing	
Light source replaceable	No	Housing Material	Aluminum extruded
Driver included	Yes	Optic material	Polycarbonate
Optical cover/lens type	PC-UV [Polycarbonate bowl/cover UV-resistant]	Optical cover/lens material	Polycarbonate
CE mark	CE mark	Length	305 mm
UL mark	UL and cUL mark	Approval and Application	
Operating and Electrical		Ingress protection code	IP66 [Dust penetration-protected, jet-proof]
Input Voltage	100 to 277 V	Mech. impact protection code	IK10 [20 J vandal-resistant]
Input Frequency	50 to 60 Hz		

ColorGraz e IntelliHue Powercore

Initial Performance (IEC Compliant)

Initial luminous flux (system flux)	697 lm
Initial luminous flux at color temperature of 2700 K	440 lm
Initial luminous flux at color temperature of 4000 K	533 lm
Initial LED luminaire efficacy	38.9 lm/W
Init. Color Rendering Index	60
Initial input power	18 W

Over Time Performance (IEC Compliant)

Lumen Maintenance 50% at 25°C Reported	75000
Lumen Maintenance 50% at 50°C Reported	70000
Lumen Maintenance 70% at 25°C Calculated	100000
Lumen Maintenance 70% at 25°C Reported	70000
Lumen Maintenance 70% at 50°C Calculated	100000
Lumen Maintenance 70% at 50°C Reported	65000

Application Conditions

Ambient temperature range	-40 to +122 °F
---------------------------	----------------

Product Data

Order product name	BCS559 30x60 RGBMW L305
EAN/UPC - Product	8718699212483
Order code	912400135878
Local order code	.
Numerator - Quantity Per Pack	1
Numerator - Packs per outer box	4
Material Nr. (12NC)	912400135878
Net Weight (Piece)	1.200 kg



Dimensional drawing

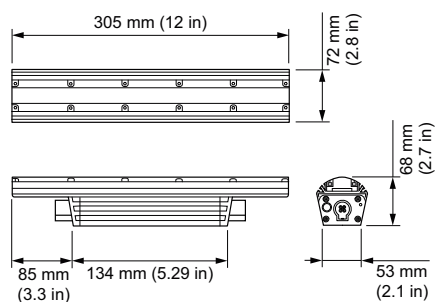

ColorGraz e IntelliHue Powercore

