



ColorGraz e IntelliHue Powercore



ColorGraz e IntelliHue Powercore, 100 to 277 VAC, 60° x 30°, 305 mm (1 ft)

ColorGraz e IntelliHue Powercore, 100 to 277 VAC, 60° x 30°, 305 mm (1 ft)

Graze is a high-performance, exterior linear luminaire designed to highlight architectural features ranging from surface textures and molding details to archways and windows. Graze IntelliHue utilizes Color Kinetics IntelliHue technology to produce millions of saturated colors, pastels, and high quality white light, in the same precisely controllable luminaire. Multiple luminaire lengths, and beam angles support a large range of façade or surface illumination applications. Low-profile housing, connectorized cabling, a universal power input range, and direct line voltage operation make Graze luminaires easy to install and operate.

Product data

General information	
Lamp family code	LED-HB [LED High Brightness]
Light source color	IntelliHue
Light source replaceable	No
Driver included	Yes
Optical cover/lens type	Polycarbonate bowl/cover UV-resistant
CE mark	CE mark
UL mark	UL and cUL mark
Light technical	
Efficacy (lm/W) @ 4000 K	44.6 lm/W

Efficacy (lm/W) @ 2700 K	47 lm/W
CRI @ 4000 K	81.4
CRI @ 2700	87.1
Operating and electrical	
Input Voltage	100 to 277 V
Input Frequency	50 to 60 Hz
Controls and dimming	
Dimmable	Yes

ColorGraz e IntelliHue Powercore

Mechanical and housing	
Housing Material	Aluminum extruded
Optic material	Polycarbonate
Optical cover/lens material	Polycarbonate
Length	305 mm
Color	Aluminum
Approval and application	
Ingress protection code	IP66 [Dust penetration-protected, jet-proof]
Energy Efficiency Class	G
Mech. impact protection code	IK10 [20 J vandal-resistant]
Vibration Standard	Complies with ANSI C136.31, 3G
Corrosion Resistance	Complies with ASTM B117 standard with special order. Please contact your Color Kinetics Lighting Sales rep for custom configurations.
FCC mark	FCC Class A
Vibration Rating	Complies with ANSI C136.31, 3G
EPREL Registration Number	887740
Initial performance (IEC compliant)	
Initial luminous flux (system flux)	692 lm
Initial luminous flux at color temperature of 2700 K	433 lm
Initial luminous flux at color temperature of 4000 K	521 lm
Initial LED luminaire efficacy	38.7 lm/W
Initial input power	18 W

Dimensional drawing

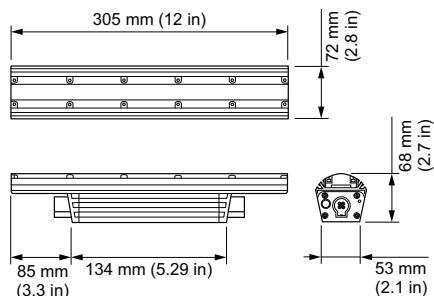

BCS559 60x30 RGBMW L305

Over time performance (IEC compliant)	
Lumen Maintenance 50% at 25°C Reported	75000
Lumen Maintenance 50% at 50°C Reported	70000
Lumen Maintenance 70% at 25°C	100000
Calculated	
Lumen Maintenance 70% at 25°C Reported	70000
Lumen Maintenance 70% at 50°C	100000
Calculated	
Lumen Maintenance 70% at 50°C Reported	65000
Application conditions	
Ambient temperature range	-40 to +50 °C
Product data	
Full product code	871869921249099
Order product name	BCS559 60x30 RGBMW L305
EAN/UPC - Product	8718699212490
Order code	423-000016-04
Numerator - Quantity Per Pack	1
Numerator - Packs per outer box	4
Material Nr. (12NC)	912400135879
Net Weight (Piece)	0.345 kg
Catalog Number	423-000016-04
Catalog Number Description	ColorGraz e IntelliHue Powercore, 100 to 277 VAC, 60° x 30°, 305 mm (1 ft)



