



HID ignitors for series systems

SX 70 220-240V 50/60Hz

HID ignitors for series systems

Product data

| General Information | |
|---|---------------------------|
| Application Code | 70 |
| Lamp Type | SOX/SOX-E |
| Number of Lamps | 1 piece/unit |
| Operating and Electrical | |
| Input Voltage | 220 to 240 V |
| Input Frequency | 50 to 60 Hz |
| Igniton Type | Parallel |
| Ignition Voltage (Max) | 1.2 kV |
| Response Voltage | 198 V |
| Mains Voltage Performance (AC) | -8% - +6% |
| Mains Voltage Safety (AC) | -10% - +10% |
| Power Losses (Nom) | 1.0 W |
| Wiring | |
| Cable Capacity Wires Device to Lamp (Nom) | 5 nF |
| Wire Striplength | 6.0 mm |
| Ballast Contact Wire Cross Section | 0.70-2.50 mm ² |
| Connector Type | Screw |

| System characteristics | |
|---------------------------------|-----------------------------|
| Rated Ballast-Lamp Power | 90 W |
| Temperature | |
| T-Ambient (Max) | 75 °C |
| T-Ambient (Min) | -20 °C |
| T-Storage (Max) | 80 °C |
| T-Storage (Min) | -25 °C |
| T-Case Maximum (Max) | 80 °C |
| Mechanical and Housing | |
| Housing | SNI-115 |
| Approval and Application | |
| Approval Marks | CE marking ENEC certificate |
| Product Data | |
| Full product code | 871150091549830 |
| Order product name | SX 70 220-240V 50/60Hz |
| EAN/UPC - Product | 8711500915498 |
| Order code | 913654039066 |
| Numerator - Quantity Per Pack | 1 |
| Numerator - Packs per outer box | 20 |

HID ignitors for series systems

| | |
|---------------------|--------------|
| Material Nr. (12NC) | 913654039066 |
| Net Weight (Piece) | 0.086 kg |

Dimensional drawing

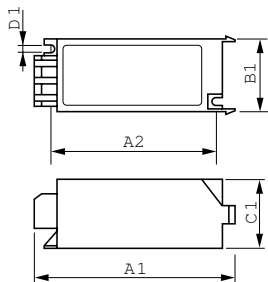

| Product | D1 | C1 | A1 | A2 | B1 |
|------------------------|--------|---------|----------|---------|---------|
| SX 70 220-240V 50/60Hz | 4.3 mm | 38.0 mm | 114.5 mm | 95.0 mm | 41.0 mm |

SX 70 220-240V 50/60Hz

