

HF-Basic II for TL-D lamps

ELE BALLAST (2) 58W TLD 230V

Affordable, reliable, CE complying, high frequency electronic ballast for TLD fluorescent lamps Ideal alternative for electromagnetic (EM) ballasts

Product data

Operating and Electrical	
Input Voltage	220 to 240 V
Line Frequency	50 to 60 Hz
Input Frequency	50 to 60 Hz
Inrush Current Width	0.35 ms
Inrush Current Peak (Max)	31 A
Number of Products on MCB (16A Type B) (Nom)	12
Wiring	
Connector Type Input Terminals	WAGO 251 universal connector [Suitable for both automatic wiring (ALF and ADS) and manual wiring]
Connector Type Output Terminals	WAGO 251 universal connector [Suitable for both automatic wiring (ALF and ADS) and manual wiring]
Cable Length From Device to Lamp	78-3/4 inch
Temperature	
Ambient temperature range	5 °F to 122 °F
T-Case Lifetime (Nom)	167 °F
T-Case Maximum (Max)	167 °F

Mechanical and Housing	
Housing	- [Not Specified]
Approval and Application	
Energy Efficiency Index	A2
Safety Standard	IEC 61347-2-3
Environmental Standard	ISO 14001
Approval Marks	CE marking ENEC certificate VDE-EMV certificate

Product Data	
Order product name	HF-B 158/258 TL-D EII 220-240V 50/60Hz
Full product name	ELE BALLAST (2) 58W TLD 230V
Full product code	871150093160330
Order code	HFB258TLDM
Material Nr. (12NC)	913700192966
Numerator - Quantity Per Pack	1
EAN/UPC - Product/Case	8711500931603
Numerator - Packs per outer box	12
EAN/UPC - Case	8711500931610

HF-Basic II for TL-D lamps

Dimensional drawing

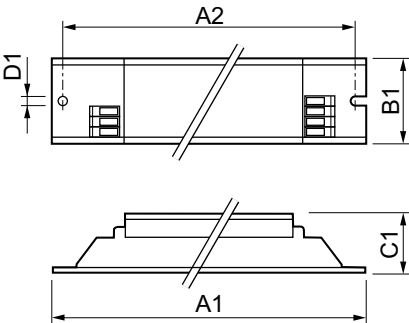

Product	D1	C1	A1	A2	B1
HF-B 158/258 TL-D Ell 220-240V 50/60Hz	3/16 inch	1-1/8 inch	11-1/16 inch	10-7/16 inch	1-3/16 inch

