

# HID-HighPower for SON/MH/HPL/HPI

## BSN 1000 L78-A2 230/240V 50Hz HP-257

Encapsulated ballasts for use with SON (T) (Plus), HPL, HPI and MH lamps with rated wattages of 1000 W and above

### Product data

<b>Operating and Electrical</b>		<b>Full product name</b>		BSN 1000 L78-A2 230/240V 50Hz HP-257	
<b>Input Voltage</b>	230 V (default) or 240 V	<b>Full product code</b>		871150006236900	
<b>Line Frequency</b>	50 Hz	<b>Order code</b>		913700217503	
<b>Input Frequency</b>	50 Hz	<b>Material Nr. (12NC)</b>		913700217503	
		<b>Numerator - Quantity Per Pack</b>		1	
		<b>EAN/UPC - Product/Case</b>		8711500996640	
		<b>Numerator - Packs per outer box</b>		1	
		<b>EAN/UPC - Case</b>		8711500062369	
<b>Approval and Application</b>					
<b>Approval Marks</b>		CE marking ENEC certificate			
<b>Product Data</b>					
<b>Order product name</b>		BSN 1000 L78-A2 230/240V 50Hz HP-257			

# HID-HighPower for SON/MH/HPL/HPI

## Dimensional drawing

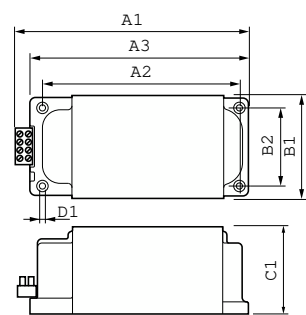

Product	D1	C1	A1	A2	A3	B1	B2
BSN 1000 L78-A2	6.5	102.0	257.0	222.0	246.0	117.0	88.0
230/240V 50Hz	mm	mm	mm	mm	mm	mm	mm
HP-257							

