



HID-HighPower for SON/MH/HPL/HPI

BHL 1000 L02 220V 50HZ HP-207

Encapsulated ballasts for use with SON (T) (Plus), HPL, HPI and MH lamps with rated wattages of 1000 W and above

Product data

Operating and Electrical		Full product name		BHL 1000 L02 220V 50HZ HP-207
Input Voltage	220 V	Full EOC		871150006231400
Line Frequency	50 Hz	Order code		06231400
Input frequency	50 Hz	Material no. (12 NC)		913700218403
		Local order code		BHL1000L02
Wiring		SAP numerator – quantity per pack		1
Connector type	Screw	EAN/UPC — Product/Case		8711500996626
		Numerator – packs per outer box		1
Approval and Application		EAN/UPC - Case		8711500062314
Approval marks	CE marking ENEC certificate			
Product Data				
Order product name	BHL 1000 L02-A2 220V 50Hz HP-207			

HID-HighPower for SON/MH/HPL/HPI

Dimensional drawing

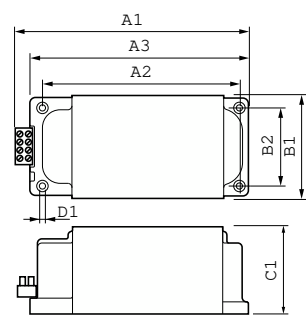

Product	D1	C1	A1	A2	A3	B1	B2
BHL 1000 L02-A2	6.5 mm	102.0	207.0	172.0	196.0	117.0	88.0
220V 50Hz		mm	mm	mm	mm	mm	mm
HP-207							

