



# HID-High Power Basic for SON/MH/HPL

## BMH 2000 L5018-A2-A

Basic aluminum/iron ballasts for use with SON (T) (Plus), HPL, HPI and MH lamps with rated wattages of 1000 W and above. Basic aluminum/iron ballasts for use with SON (T) (Plus), HPL, HPI and MH lamps with rated wattages of 1000 W and above

### Product data

General Information	
Application Code	L5018-A2-A
Design	MHN
Lamp Type	MHN-LA/FC
Number of Lamps	1 piece/unit
Operating and Electrical	
Input Voltage	380 to 415 V
Input Frequency	50 Hz
Input Voltage (Multi-Tab)	380/400/415
Mains Voltage Performance (AC)	-8% - +6%
Mains Voltage Safety (AC)	-10% - +10%
Wiring	
Wire Striplength	7.0 mm
Ballast Contact Wire Cross Section	0.70-6.00 mm <sup>2</sup>
Connector Type	Screw
System characteristics	
Capacitor	60µF/450V
Rated Ballast-Lamp Power	2000 W
Recommended Ignitor	Series ignitor

Temperature	
T-Storage (Max)	80 °C
T-Storage (Min)	-25 °C
T-Winding (Max)	130 °C
Delta-T Normal Conditions	60/80 °C

Approval and Application	
Approval Marks	CE marking ENEC certificate

Product Data	
Full product code	871829111851000
Order product name	BMH 2000 L5018-A2-A
EAN/UPC - Product	8718291118510
Order code	913700275326
Numerator - Quantity Per Pack	1
Numerator - Packs per outer box	1
Material Nr. (12NC)	913700275326
Net Weight (Piece)	17.000 kg

# HID-High Power Basic for SON/MH/HPL

## Dimensional drawing

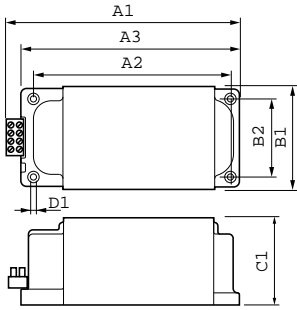

Product	D1	C1	A1	A2	A3	B1	B2
BMH 2000	6.5	111.0	317.0	284.0	317.0	126.0	106.0
L5018-A2-A	mm	mm	mm	mm	mm	mm	mm

BMH 2000 L5018-A

