



HID-Basic BHL MK4 for HPL/HPI

BHL 250 K307 230/240V 50Hz BC2-134

Impregnated electromagnetic copper/iron ballasts for HPL, HPI (Plus) and SON-H lamps

Product data

Operating and Electrical		Full product name		BHL 250 K307 230/240V 50Hz BC2-134
Input Voltage	230 V (default) or 240 V	Full product code		872790088701300
Line Frequency	50 Hz	Order code		88701300
Input Frequency	50 Hz	Material Nr. (12NC)		913700278026
Wiring		Numerator - Quantity Per Pack		1
Connector Type	Screw	EAN/UPC - Product/Case		8711500881588
Approval and Application		Numerator - Packs per outer box		6
Approval Marks	CE marking ENEC certificate	EAN/UPC - Case		8727900887013
Product Data				
Order product name	BHL 250 K307-A2 230/240V 50Hz BC2-134			

HID-Basic BHL MK4 for HPL/HPI

Dimensional drawing

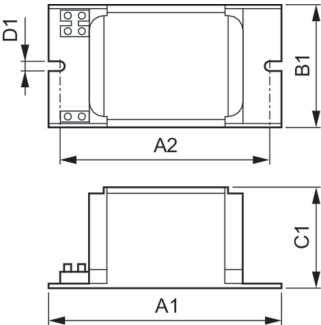

Product	D1	C1	A1	A2	B1
BHL 250 K307-A2 230/240V 50Hz	6.2 mm	65.0 mm	134.0 mm	113.0 mm	76.0 mm
BC2-134					

