



# HID-Basic BHL MK4 for HPL/HPI

## BHL 400 K307 230/240V 50Hz BC2-160

Impregnated electromagnetic copper/iron ballasts for HPL, HPI (Plus) and SON-H lamps

### Product data

<b>Operating and Electrical</b>		<b>Full product name</b>		BHL 400 K307 230/240V 50Hz BC2-160
<b>Input Voltage</b>	230 V (default) or 240 V	<b>Full product code</b>		872790088703700
<b>Line Frequency</b>	50 Hz	<b>Order code</b>		88703700
<b>Input Frequency</b>	50 Hz	<b>Material Nr. (12NC)</b>		913700278226
		<b>Numerator - Quantity Per Pack</b>		1
		<b>EAN/UPC - Product/Case</b>		8711500881595
		<b>Numerator - Packs per outer box</b>		6
		<b>EAN/UPC - Case</b>		8727900887037
<b>Approval and Application</b>				
<b>Approval Marks</b>	CE marking ENEC certificate			
<b>Product Data</b>				
<b>Order product name</b>	BHL 400 K307-A2 230/240V 50Hz BC2-160			

# HID-Basic BHL MK4 for HPL/HPI

## Dimensional drawing

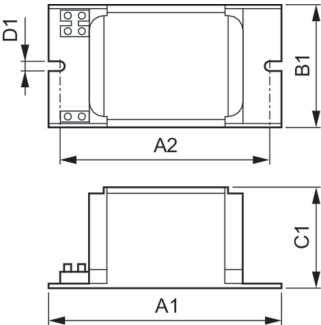

Product	D1	C1	A1	A2	B1
BHL 400 K307-A2 230/240V 50Hz	6.2 mm	65.0 mm	160.0 mm	139.0 mm	76.0 mm
BC2-160					

