



HID-Basic BHL for HPL/HPI

BHL 400 K202 230V 50Hz BC2-151

Impregnated electromagnetic copper/iron ballasts for HPL and HPI (Plus) lamps

Product data

Operating and Electrical	
Input Voltage	230 V
Line Frequency	50 Hz
Input Frequency	50 Hz
Wiring	
Connector Type	Screw
Approval and Application	
Approval Marks	CE marking ENEC certificate
Product Data	
Order product name	BHL 400 K202-A2 230V 50Hz BC2-151

Full product name	BHL 400 K202 230V 50Hz BC2-151
Full product code	872790094076300
Order code	94076300
Material Nr. (12NC)	913700284626
Numerator - Quantity Per Pack	1
EAN/UPC - Product/Case	8727900940763
Numerator - Packs per outer box	6
EAN/UPC - Case	8727900940770

HID-Basic BHL for HPL/HPI

Dimensional drawing

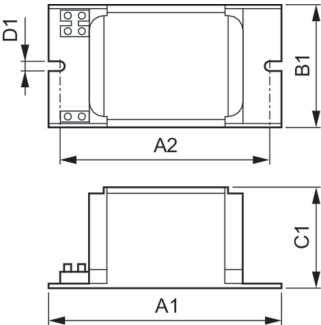

Product	D1	C1	A1	A2	B1
BHL 400 K202-A2 230V 50Hz	6.2 mm	65.0 mm	150.0 mm	129.0 mm	76.0 mm
BC2-151					

