



# HID-Basic BHL for HPL/HPI

## BHL 400 K202-A2 230V 50Hz BC2-151

Impregnated electromagnetic copper/iron ballasts for HPL, HPI (Plus) and SON-H lamps

### Product data

<b>Operating and Electrical</b>	
Input Voltage	230 V
Line Frequency	50 Hz
Input Frequency	50 Hz
<b>Wiring</b>	
Connector Type	Screw
<b>Approval and Application</b>	
Approval Marks	CE marking ENEC certificate
<b>Product Data</b>	
Order product name	BHL 400 K202-A2 230V 50Hz BC2-151

Full product name	BHL 400 K202-A2 230V 50Hz BC2-151
Full product code	872790094076300
Order code	913700284626
Material Nr. (12NC)	913700284626
Numerator - Quantity Per Pack	1
EAN/UPC - Product/Case	8727900940763
Numerator - Packs per outer box	6
EAN/UPC - Case	8727900940770

# HID-Basic BHL for HPL/HPI

## Dimensional drawing

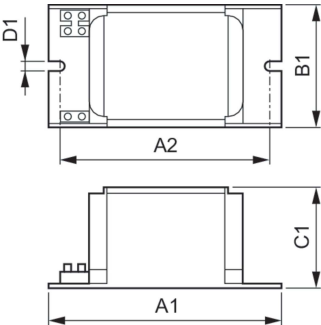

Product	D1	C1	A1	A2	B1
BHL 400 K202-A2 230V 50Hz	6.2 mm	65.0 mm	150.0 mm	129.0 mm	76.0 mm
BC2-151					

