

HF-Matchbox Red

HF-M RED 118 SH PL-C/PL-T 230-240V

Compact, lightweight, High Frequency electronic ballast for TL (8-18W), TL5 (14-24W) and compact fluorescent PL (7-24W) lamps

Product data

| Operating and Electrical | |
|--|-----------------|
| Input Voltage | 230 to 240 V |
| Line Frequency | 50 to 60 Hz |
| Input Frequency | 50 to 60 Hz |
| Number of Products on MCB (16A Type B) (Nom) | 73 |
| Wiring | |
| Connector Type Input Terminals | Insert |
| Color Input Terminals | Orange |
| Color Output Terminals | Grey |
| Connector Type Output Terminals | Insert |
| Cable Length From Device to Lamp | 1.50 m |
| Temperature | |
| Ambient temperature range | -10 °C to 40 °C |
| T-Case Maximum (Max) | 75 °C |
| Mechanical and Housing | |
| Housing | SH |

| Approval and Application | |
|---------------------------------|--|
| Ingress protection code | IP20 [Finger-protected] |
| Approval Marks | F-Marking CE marking ENEC certificate CB Certificate |
| Product Data | |
| Order product name | HF-M RED 118 SH PL-C/PL-T 230-240V |
| Full product name | HF-M RED 118 SH PL-C/PL-T 230-240V |
| Full product code | 871150092802330 |
| Order code | 92802330 |
| Material Nr. (12NC) | 913700423466 |
| Numerator - Quantity Per Pack | 1 |
| EAN/UPC - Product/Case | 8711500928023 |
| Numerator - Packs per outer box | 50 |
| EAN/UPC - Case | 8711500928030 |

HF-Matchbox Red

Dimensional drawing

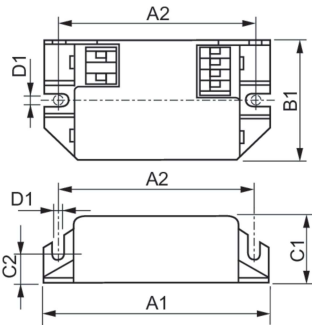

| Product | D1 | C1 | C2 | A1 | A2 | B1 |
|--|--------|---------|---------|---------|---------|---------|
| HF-M RED 118 SH PL-C/PL- T 230-240V | 4.4 mm | 22.0 mm | 10.0 mm | 80.0 mm | 70.0 mm | 40.0 mm |

