

HF-Matchbox Red

HF-M RED 118 SH PL-C/PL-T 230-240V

HF-Matchbox Red is an affordable, reliable, compact, lightweight and high-frequency ballast for use with system wattages below 25 W in combination with TL mini, TL-D, TL5 and TL5c, PL-T/C, and PL-L/S lamps. The HF-M Red range has a robust design, meets all relevant international safety and performance standards and has an energy efficiency index (CELMA EEI) of A2.

Product data

| Operating and Electrical | |
|--|---------------|
| Input Voltage | 230 to 240 V |
| Line Frequency | 50 to 60 Hz |
| Input frequency | 50 to 60 Hz |
| Number of products on MCB (16 A type B) (nom.) | 73 |
| Wiring | |
| Connector type input terminals | Insert |
| Colour input terminals | Orange |
| Colour output terminals | Grey |
| Connector type output terminals | Insert |
| Cable length from device to lamp | 1.50 m |
| Temperature | |
| Ambient temperature range | -10°C to 40°C |
| T-Case maximum (max.) | 75 °C |
| Mechanical and Housing | |
| Housing | SH |

| Approval and Application | |
|-----------------------------------|--|
| Ingress protection code | IP20 [Finger-protected] |
| Approval marks | F-Marking CE marking ENEC certificate CB certificate |
| Product Data | |
| Order product name | HF-M RED 118 SH PL-C/PL-T 230-240V |
| Full product name | HF-M RED 118 SH PL-C/PL-T 230-240V |
| Full EOC | 871150092802330 |
| Order code | 92802330 |
| Material no. (12 NC) | 913700423466 |
| Local order code | HFMRED118SH |
| SAP numerator – quantity per pack | 1 |
| EAN/UPC – Product/Case | 8711500928023 |
| Numerator – packs per outer box | 50 |
| EAN/UPC – Case | 8711500928030 |

HF-Matchbox Red

Dimensional drawing

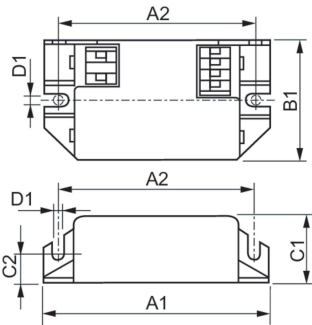

| Product | D1 | C1 | C2 | A1 | A2 | B1 |
|--|--------|---------|---------|---------|---------|---------|
| HF-M RED 118 SH PL-C/PL- T 230-240V | 4.4 mm | 22.0 mm | 10.0 mm | 80.0 mm | 70.0 mm | 40.0 mm |

