



# Core & Coil (71A) HPS ~LT~ 200W

## CORE & COIL HID HPS BAL 150W S55 120/220/240V 50HZ C&C

The basic ballast is the open core and coil which is most often used as a component within a lighting luminaire. The core and coil also forms the nucleus of Philips Advance's five other ballast configurations.

### Product data

General Information	
ANSI Code	S55
Lamp Type	150W HPS
Number of Lamps	1 piece/unit
Circuit Type	HX-HPF
Ballast Type	Magnetic HID
Base Model	71A81N2
Core Size	3 X 4 (2 coil)
Suitable For Outdoor Use	Yes
Ignitor Catalog Number	LI551-H4
Ignitor Temperature Rating	105°C
Capacitor Value	17.5 MFD
Capacitor Catalog Number	7C175M30RA
Capacitor Requirements	260V
Capacitor Temperature Rating	105°C
Capacitor Diameter/Oval Dimensions	1.65 in
Capacitor Height	3.7 in
Automatic Restart	No

Operating and Electrical	
Input Voltage	120/220/240 V
Input Frequency	50 Hz
Input Current (Open Circuit)	3/1.7/1.55 A
Input Current (Starting)	1.5/0.85/0.75 A
Input Current (Short Circuit)	0.35-0.54/0.18-0.29/0.16-0.25 A
Secondary Short Circuit Current	3.15-3.85 A
Constant Wattage Deviation	Within Trapezoid
Ballast Factor (Nom)	1
Power Factor (Nom)	0.90
Open Circuit Voltage	120 V
Input Current (Nom)	1.6/0.9/0.8 A A
Input Power (Nom)	188 W
Rated Lamp Power	150 W

Wiring	
Wire Striplength	0.5 mm
Wire Length by Color	12"
Wire Type	Stranded
Remote Wiring Configuration Allowed	Yes

## Core & Coil (71A) HPS ~LT~ 200W

Max Ballast-Lamp Distance Remote	2'
Wiring	
Recommended Fuse Value	8/5/4 A
<b>Approval and Application</b>	
Open Circuit Voltage Test (Volts)	110-130 V
Approval Marks	ULR CSA certificate RoHS Compliant
Temperature Marking	C/B/B
UL Recognized	Yes
Hipot Test (1 Minute)	2000 V
Hipot Test (2 Seconds)	2500 V
UL Insulation Class	H(180°C)
UL Temperature Code	1029C

<b>Product Data</b>	
Order product name	CORE & COIL HID HPS BAL 150W S55
	120/220/240V 50HZ C&C
EAN/UPC - Product	781087028568
Order code	176305
Local order code	176305
Numerator - Quantity Per Pack	1
Numerator - Packs per outer box	4
Material Nr. (12NC)	913700500481
Net Weight (Piece)	4.237 kg

### Dimensional drawing

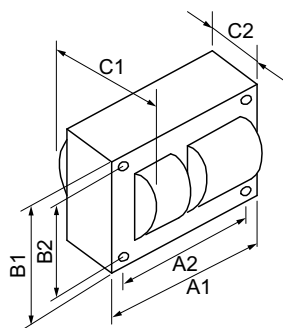

HPS BAL 150W S55 120/220/240V 50HZ C&C

Product	C1	C2	A1	A2	B1	B2
CORE & COIL HID HPS BAL 150W S55	4.2 in	2.95 in	3.9 in	3.5 in	2.8 in	2.4 in
120/220/240V 50HZ C&C						

