

Core & Coil (71A) HPS ~LT~ 200W

**CORE & COIL HID HPS BAL 150W S55
120/220/240V 50HZ C&C**

The basic ballast is the open core and coil which is most often used as a component within a lighting luminaire. The core and coil also forms the nucleus of Philips Advance's five other ballast configurations.

Product data

| General Information | |
|------------------------------------|----------------|
| ANSI Code | S55 |
| Lamp Type | 150W HPS |
| Number of Lamps | 1 piece/unit |
| Circuit Type | HX-HPF |
| Ballast Type | Magnetic HID |
| Base Model | 71A81N2 |
| Core Size | 3 X 4 (2 coil) |
| Suitable For Outdoor Use | Yes |
| Ignitor Catalog Number | LI551-H4 |
| Ignitor Temperature Rating | 105°C |
| Capacitor Value | 17.5 MFD |
| Capacitor Catalog Number | 7C175M30RA |
| Capacitor Requirements | 260V |
| Capacitor Temperature Rating | 105°C |
| Capacitor Diameter/Oval Dimensions | 1.65 in |
| Capacitor Height | 3.7 in |
| Automatic Restart | No |

Operating and Electrical

| | |
|--|---------------------------------|
| Input Voltage | 120/220/240 V |
| Input Frequency | 50 Hz |
| Inp. Current (Open Circuit) | 3/1.7/1.55 A |
| Input Current (Starting) | 1.5/0.85/0.75 A |
| Input Current (Short Circuit) | 0.35-0.54/0.18-0.29/0.16-0.25 A |
| Secondary Short Circuit Current | 3.15-3.85 A |
| Constant Wattage Deviation | Within Trapezoid |
| Ballast Factor (Nom) | 1 |
| Power Factor (Nom) | 0.90 |
| Nominal Open Circuit Voltage | 120 V |
| Input Current (Operating) (Nom) | 1.6/0.9/0.8 A A |
| Input Power (Nom) | 188 W |
| Rated Lamp Watts | 150 W |

Wiring

| | |
|-------------------------------------|----------|
| Wire Striplength | 0.5 mm |
| Wire Length by Color | 12" |
| Wire Type | Stranded |
| Remote Wiring Configuration Allowed | Yes |

Core & Coil (71A) HPS ~LT~ 200W

| | |
|-----------------------------------|------------------------------------|
| Max Ballast-Lamp Distance Remote | 2' |
| Wiring | |
| Recommended Fuse Value | 8/5/4 A |
| Approval and Application | |
| Open Circuit Voltage Test (Volts) | 110-130 V |
| Approbation Marks | ULR CSA certificate RoHS Compliant |
| Temperature Marking | C/B/B |
| UL Recognized | Yes |
| Hipot Test (1 Minute) | 2000 V |
| Hipot Test (2 Seconds) | 2500 V |
| UL Insulation Class | H(180°C) |
| UL Temperature Code | 1029C |

| | |
|---------------------------------|---|
| Product Data | |
| Order product name | CORE & COIL HID HPS BAL 150W S55 120/220/240V 50HZ C&C |
| EAN/UPC - Product | 781087028568 |
| Order code | 71A81N2500D |
| Numerator - Quantity Per Pack | 1 |
| Numerator - Packs per outer box | 4 |
| Material Nr. (12NC) | 913700500481 |
| Net Weight (Piece) | 4.237 kg |

Dimensional drawing

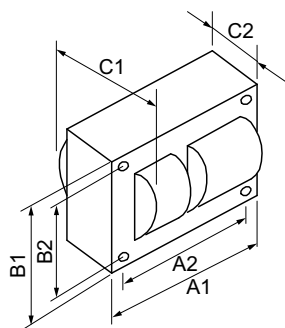

| Product | C1 | C2 | A1 | A2 | B1 | B2 |
|---|--------|---------|--------|--------|--------|--------|
| CORE & COIL HID HPS BAL 150W S55 120/220/240V 50HZ C&C | 4.2 in | 2.95 in | 3.9 in | 3.5 in | 2.8 in | 2.4 in |

HPS BAL 150W S55 120/220/240V 50HZ C&C

