



Core & Coil (71A) HPS ~LT~ 200W

CORE & COIL HID HPS BAL 150W S55
120/220/240V 50HZ C&C

The basic ballast is the open core and coil which is most often used as a component within a lighting luminaire. The core and coil also forms the nucleus of Philips Advance's five other ballast configurations.

Product data

General Information	
ANSI Code	S55
Lamp Type	150W HPS
Number of Lamps	1 piece/unit
Circuit Type	HX-HPF
Ballast Type	Magnetic HID
Base Model	71A81N2
Core Size	3 X 4 (2 coil)
Suitable For Outdoor Use	Yes
Ignitor Catalog Number	LI551-H4
Ignitor Temperature Rating	105°C
Capacitor Value	17.5 MFD
Capacitor Catalog Number	7C175M30RA
Capacitor Requirements	260V
Capacitor Temperature Rating	105°C
Capacitor Diameter/Oval Dimensions	1.65 in
Capacitor Height	3.7 in
Automatic Restart	No

Operating and Electrical	
Input Voltage	120/220/240 V
Input Frequency	50 Hz
Input Current (Open Circuit)	3/1.7/1.55 A
Input Current (Starting)	1.5/0.85/0.75 A
Input Current (Short Circuit)	0.35-0.54/0.18-0.29/0.16-0.25 A
Secondary Short Circuit Current	3.15-3.85 A
Constant Wattage Deviation	Within Trapezoid
Ballast Factor (Nom)	1
Power Factor (Nom)	0.90
Open Circuit Voltage	120 V
Input Current (Nom)	1.6/0.9/0.8 A A
Input Power (Nom)	188 W
Rated Lamp Power	150 W
Wiring	
Wire Striplength	0.5 mm
Wire Length by Color	12"
Wire Type	Stranded
Remote Wiring Configuration Allowed	Yes

Core & Coil (71A) HPS ~LT~ 200W

Max Ballast-Lamp Distance Remote	2'
Wiring	
Recommended Fuse Value	8/5/4 A
Approval and Application	
Open Circuit Voltage Test (Volts)	110-130 V
Approval Marks	ULR CSA certificate RoHS Compliant
Temperature Marking	C/B/B
UL Recognized	Yes
Hipot Test (1 Minute)	2000 V
Hipot Test (2 Seconds)	2500 V
UL Insulation Class	H(180°C)
UL Temperature Code	1029C

Product Data	
Order product name	CORE & COIL HID HPS BAL 150W S55 120/220/240V 50HZ C&C
EAN/UPC - Product	781087028568
Order code	913700500481
Numerator - Quantity Per Pack	1
Numerator - Packs per outer box	4
Material Nr. (12NC)	913700500481
Net Weight (Piece)	4.237 kg

Dimensional drawing

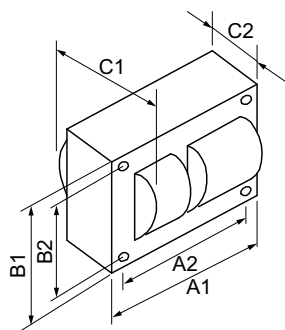

HPS BAL 150W S55 120/220/240V 50HZ C&C

Product	C1	C2	A1	A2	B1	B2
CORE & COIL HID HPS BAL 150W S55 120/220/240V 50HZ C&C	4.2 in	2.95 in	3.9 in	3.5 in	2.8 in	2.4 in

