



Core & Coil (71A) MH ~LT~ 175W

**CORE & COIL HID MH BAL 100W M90/140
120/220/240 50HZ C&C**

The basic ballast is the open core and coil which is most often used as a component within a lighting luminaire. The core and coil also forms the nucleus of Philips Advance's five other ballast configurations.

Product data

General Information	
ANSI Code	M90-M140
Lamp Type	100 MH
Number of Lamps	1 piece/unit
Circuit Type	HX-HPF
Ballast Type	Magnetic HID
Base Model	71A53N0
Core Size	3 X 4 (2 coil)
Suitable For Outdoor Use	Yes
Ignitor Catalog Number	LI533-H4
Ignitor Temperature Rating	105°C
Capacitor Value	17.5 MFD
Capacitor Catalog Number	7C175M30RA
Capacitor Requirements	240V
Capacitor Temperature Rating	105°C
Capacitor Diameter/Oval Dimensions	1.65 in
Capacitor Height	3.7 in
Automatic Restart	No

Operating and Electrical

Input Voltage	120/220/240 V
Input Frequency	50 Hz
Inp. Current (Open Circuit)	2.2/1.2/1.1 A
Input Current (Starting)	1.3/0.7/0.65 A
Input Current (Short Circuit)	0.32-0.52/0.15-0.3/0.16-0.25 A
Secondary Short Circuit Current	1-1.25 A
Constant Wattage Deviation	12%
Ballast Factor (Nom)	1
Power Factor (Nom)	0.90
Nominal Open Circuit Voltage	266 V
Input Current (Operating) (Nom)	1.15/0.65/0.6 A A
Input Power (Nom)	129 W
Rated Lamp Watts	100 W

Wiring

Wire Striplength	0.5 mm
Wire Length by Color	12"
Wire Type	Stranded
Remote Wiring Configuration Allowed	Yes

Core & Coil (71A) MH ~LT~ 175W

Max Ballast-Lamp Distance Remote	15'
Wiring	
Recommended Fuse Value	6/3/3 A

Approval and Application

Open Circuit Voltage Test (Volts)	240-295 V
Approbation Marks	RoHS Compliant CSA certificate
Temperature Marking	A/A/A
UL Recognized	Yes
Hipot Test (1 Minute)	2000 V
Hipot Test (2 Seconds)	2500 V
UL Insulation Class	H(180°C)
UL Temperature Code	1029A

Product Data

Order product name	CORE & COIL HID MH BAL 100W M90/140 120/220/240 50HZ C&C
EAN/UPC - Product	781087079348
Order code	71A53N0500D
Numerator - Quantity Per Pack	1
Numerator - Packs per outer box	4
Material Nr. (12NC)	913700500571
Net Weight (Piece)	3.071 kg

Dimensional drawing

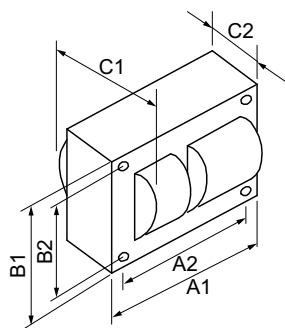

MH BAL 100W M90/140 120/220/240 50HZ C&C

Product	C1	C2	A1	A2	B1	B2
CORE & COIL HID 71A53N0500D	3.2 in	1.9 in	3.9 in	3.5 in	2.8 in	2.4 in

