

PHILIPS

Lighting



Core & Coil (71A) HPS 200W - 400W

The basic ballast is the open core and coil which is most often used as a component within a lighting luminaire. The core and coil also forms the nucleus of Philips Advance's five other ballast configurations.

Product data

General Information	
ANSI Code	S51-M169
Lamp type	400W HPS
Number of lamps	1 piece/unit
Circuit type	CWA
Ballast type	Magnetic HID
Base model	71A8493
Core size	4 x 4 (2 coil)
Suitable for outdoor use	Yes
Ignitor catalogue number	LI501-H4
Ignitor temperature rating	105°C
Capacitor value	55 MFD
Capacitor catalogue number	7C550P24RA
Capacitor requirements	240V
Capacitor temperature rating	105°C
Capacitor diameter/oval dimensions	1.85 in
Capacitor height	3.70 in
Automatic restart	No

Operating and Electrical

Input voltage	120/208/240/277 V
Input frequency	60 Hz
Input current (open circuit)	2/1.2/0.95/0.85 A
Input current (starting)	3.3/1.8/1.5/1.4 A

Input current (short circuit)	2.4-3.6/1.4-2.1/1.2-1.8/1-1.55 A
Secondary short-circuit current	6-7.4 A
Constant wattage deviation	Within Trapezoid
Ballast factor (nom.)	1
Power factor (nom.)	0.90
Open circuit voltage	190 V
Input current (nom.)	3.8/2.2/1.9/1.7 A A
Input power (nom.)	464 W
Rated lamp power	400 W

Wiring

Wire strip length	0.5 mm
Wire length by colour	12"
Wire type	Stranded
Remote wiring configuration allowed	Yes
Max. ballast-lamp distance remote wiring	2'
Recommended fuse value	10/8/5/5 A

Approval and Application

Open circuit voltage test (volts)	170-210 V
Approval marks	ULR CSA certificate RoHS Compliant
Temperature marking	D/D/D/D
UL recognised	Yes

Core & Coil (71A) HPS 200W - 400W

Hipot test (1 minute)	2000 V
Hipot test (2 seconds)	2500 V
UL insulation class	H(180°C)
UL temperature code	1029D

Product Data

Order product name	CORE & COIL HID HPS BAL 400W S51 QUAD C&C
--------------------	--

EAN/UPC – product	781087037119
Numerator – quantity per pack	1
Numerator – packs per outer box	3
Material no. (12NC)	913700501681
Net weight (piece)	6.854 kg

Dimensional drawing

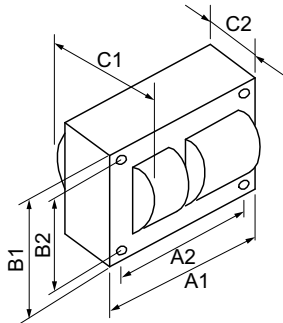

HPS BAL 400W S51 QUAD C&C

Product	C1	C2	A1	A2	B1	B2
CORE & COIL HID 71A8493510D	4 in	2.09 in	4.8 in	4.4 in	4.3 in	3.9 in

