



# Core & Coil (71A) MH ~LT~ 175W

The basic ballast is the open core and coil which is most often used as a component within a lighting luminaire. The core and coil also forms the nucleus of Philips Advance's five other ballast configurations.

## Product data

General Information			
ANSI Code	M102-M142	Input current (short circuit)	1.03-1.41/0.61-0.92/0.49-0.74/0.44-0.67 A
Lamp type	150W MH	Secondary short-circuit current	2.05-2.55 A
Number of lamps	1 piece/unit	Constant wattage deviation	12%
Circuit type	HX-HPF	Ballast factor (nom.)	1
Ballast type	Magnetic HID	Power factor (nom.)	0.90
Base model	71A5492	Open circuit voltage	250 V
Core size	3 X 4 (2 LW)	Input current (nom.)	1.6/0.96/0.8/0.7 A A
Suitable for outdoor use	Yes	Input power (nom.)	185 W
Ignitor catalogue number	LI533-H4	Rated lamp power	150 W
Ignitor temperature rating	105°C		
Capacitor value	16 MFD	Wiring	
Capacitor catalogue number	7C160M30RA	Wire strip length	0.5 mm
Capacitor requirements	280V	Wire length by colour	12"
Capacitor temperature rating	105°C	Wire type	Stranded
Capacitor diameter/oval dimensions	1.65 in	Remote wiring configuration allowed	Yes
Capacitor height	2.75 in	Max. ballast-lamp distance remote wiring	10'
Automatic restart	No	Recommended fuse value	10/5/5/4 A
Operating and Electrical			
Input voltage	120/208/240/277 V	Approval and Application	
Input frequency	60 Hz	Open circuit voltage test (volts)	235-290 V
Input current (open circuit)	3.5/2.04/1.73/1.52 A	Approval marks	ULR CSA certificate RoHS Compliant
Input current (starting)	1.75/1.3/0.85/0.77 A	Temperature marking	C/B/B/A
		UL recognised	Yes
		Hipot test (1 minute)	2000 V

Core & Coil (71A) MH ~LT~ 175W

Hipot test (2 seconds)	2500 V
UL insulation class	H(180°C)
UL temperature code	1029C

Product Data

Order product name	CORE & COIL HID 71A5492510D
EAN/UPC – product	781087018309

Numerator – quantity per pack	1
Numerator – packs per outer box	4
Material no. (12NC)	913700502781
Net weight (piece)	3.217 kg

Dimensional drawing

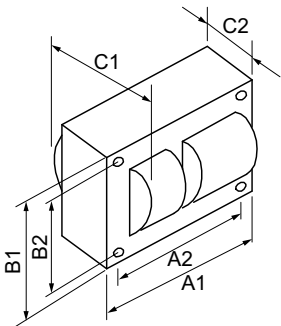

MH BAL 150W M102/142 QUAD KIT

Product	C1	C2	A1	A2	B1	B2
CORE & COIL HID 71A5492510D	3.9 in	2.25 in	3.9 in	3.5 in	2.8 in	2.4 in

