



Core & Coil (71A) MH 175W – 450W

CORE & COIL HID MH BAL 400W M59 120/277/347V C&C

The basic ballast is the open core and coil which is most often used as a component within a lighting luminaire. The core and coil also forms the nucleus of Philips Advance's five other ballast configurations.

Product data

| General Information | |
|------------------------------------|------------------------|
| ANSI Code | M59 |
| Lamp Type | 400W MH |
| Number of Lamps | 1 piece/unit |
| Circuit Type | CWA |
| Ballast Type | Magnetic HID |
| Base Model | 71A60A1A |
| Core Size | 4 1/4 x 4 3/4 (2 coil) |
| Suitable For Outdoor Use | Yes |
| Ignitor Catalog Number | NA |
| Ignitor Temperature Rating | NA |
| Capacitor Value | 24 MFD |
| Capacitor Requirements | 400V |
| Capacitor Temperature Rating | 105°C |
| Capacitor Diameter/Oval Dimensions | 1.75 in |
| Capacitor Height | 4.8 in |
| Automatic Restart | No |
| Operating and Electrical | |
| Input Voltage | 120/277/347 V |

| Input Frequency | 60 Hz |
|--------------------------------------|------------------------------|
| Input Current (Open Circuit) | 2.6/1.2/0.9 A |
| Input Current (Starting) | 2.6/1.2/0.9 A |
| Input Current (Short Circuit) | 2.75-4.2/1.2-1.8/0.95-1.45 A |
| Secondary Short Circuit Current | 3.5-4.3 A |
| Constant Wattage Deviation | 10% |
| Ballast Factor (Nom) | 1.0 |
| Power Factor (Nom) | 0.90 |
| Open Circuit Voltage | 300 V |
| Input Current (Nom) | 4/1.75/1.4 A A |
| Input Power (Nom) | 460 W |
| Rated Lamp Power | 400 W |
| Wiring | |
| Wire Striplength | 0.5 mm |
| Wire Length by Color | 12" |
| Wire Type | Stranded |
| Remote Wiring Configuration Allowed | Yes |
| Tandem Wiring Configuration Allowed | No |
| Through Wiring Configuration Allowed | No |

Core & Coil (71A) MH 175W - 450W

| | |
|---|------------------------|
| Max Ballast-Lamp Distance Remote Wiring | Determined by AWG used |
| Recommended Fuse Value | 10/5/4 A |

Mechanical and Housing

| | |
|--------------------|----|
| Housing | NA |
| Housing Dimensions | NA |

Approval and Application

| | |
|-----------------------------------|------------------------------------|
| Open Circuit Voltage Test (Volts) | 270-330 V |
| EMC Immunity Standard | NA |
| Approval Marks | ULR CSA certificate RoHS Compliant |
| Temperature Marking | D/D/D |
| Hum And Noise Level | NA |
| UL Recognized | Yes |
| Hipot Test (1 Minute) | 2000 V |
| Hipot Test (2 Seconds) | 2500 V |

| | |
|---------------------|----------|
| UL Insulation Class | H(180°C) |
| UL Temperature Code | 1029D |

Product Data

| | |
|---------------------------------|---|
| Order product name | CORE & COIL HID MH BAL 400W M59 120/277/347V C&C |
| EAN/UPC - Product | 781087097816 |
| Order code | 178673 |
| Local order code | 178673 |
| Numerator - Quantity Per Pack | 1 |
| Numerator - Packs per outer box | 4 |
| Material Nr. (12NC) | 913700503911 |
| Net Weight (Piece) | 5.562 kg |

Dimensional drawing

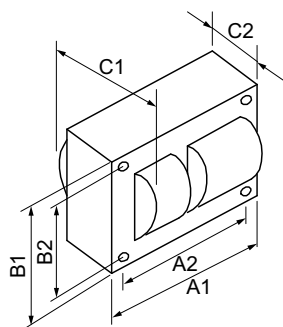

MH BAL 400W M59 120/277/347V C&C

| Product | C1 | C2 | A1 | A2 | B1 | B2 |
|---|---------|---------|--------|--------|--------|--------|
| CORE & COIL HID MH BAL 400W M59 120/277/347V C&C | 4.00 in | 2.15 in | 4.8 in | 4.4 in | 4.3 in | 3.9 in |

