



Core & Coil (71A) HPS ~LT~ 200W

CORE & COIL HID HPS BAL 70W S62 QUAD C&C

The basic ballast is the open core and coil which is most often used as a component within a lighting luminaire. The core and coil also forms the nucleus of Philips Advance's five other ballast configurations.

Product data

General Information			
ANSI Code	S62	Input Frequency	60 Hz
Lamp Type	70W HPS	Input Current (Open Circuit)	1.46/0.86/0.73/0.64 A
Number of Lamps	1 piece/unit	Input Current (Starting)	0.85/0.51/0.43/0.39 A
Circuit Type	HX-HPF	Input Current (Short Circuit)	0.6-0.95/0.35-0.6/0.3-0.5/0.25-0.4 A
Ballast Type	Magnetic HID	Secondary Short Circuit Current	2.1-2.45 A
Base Model	71A7991	Constant Wattage Deviation	Within Trapezoid
Core Size	3 X 4 (2 LW)	Ballast Factor (Nom)	1
Suitable For Outdoor Use	Yes	Power Factor (Nom)	0.90
Ignitor Catalog Number	LI551-H4	Open Circuit Voltage	120 V
Ignitor Temperature Rating	105°C	Input Current (Nom)	0.81/0.47/0.4/0.35 A A
Capacitor Value	7 MFD	Input Power (Nom)	96 W
Capacitor Catalog Number	7C070L30RA	Rated Lamp Power	70 W
Capacitor Requirements	280V	Wiring	
Capacitor Temperature Rating	105°C	Wire Striplength	0.5 mm
Capacitor Diameter/Oval Dimensions	1.25 in	Wire Length by Color	12"
Capacitor Height	2.75 in	Wire Type	Stranded
Automatic Restart	No	Remote Wiring Configuration Allowed	Yes
Operating and Electrical		Max Ballast-Lamp Distance Remote	2'
Input Voltage	120/208/240/277 V	Wiring	

Core & Coil (71A) HPS ~LT~ 200W

Recommended Fuse Value	5/3/2/2 A
Approval and Application	
Open Circuit Voltage Test (Volts)	110-130 V
Approval Marks	ULR CSA certificate RoHS Compliant
Temperature Marking	B/C/B/C
UL Recognized	Yes
Hipot Test (1 Minute)	2000 V
Hipot Test (2 Seconds)	2500 V
UL Insulation Class	H(180°C)
UL Temperature Code	1029C

Product Data	
Order product name	CORE & COIL HID HPS BAL 70W S62 QUAD C&C
EAN/UPC - Product	781087025871
Order code	913700504631
Numerator - Quantity Per Pack	1
Numerator - Packs per outer box	4
Material Nr. (12NC)	913700504631
Net Weight (Piece)	2.332 kg

Dimensional drawing

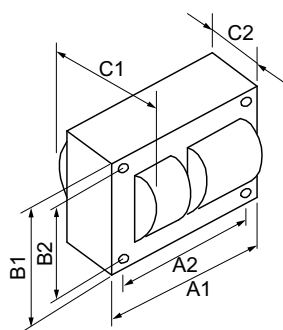

Product	C1	C2	A1	A2	B1	B2
CORE & COIL HID 71A7991510D	2.9 in	1.52 in	3.9 in	3.5 in	2.8 in	2.4 in

HPS BAL 70W S62 QUAD C&C

