

Core & Coil (71A) HPS ~LT~ 200W

CORE & COIL HID HPS BAL 150W S55 120/277/347V C&C

The basic ballast is the open core and coil which is most often used as a component within a lighting luminaire. The core and coil also forms the nucleus of Philips Advance's five other ballast configurations.

Product data

General Information		Operating and Electrical	
ANSI Code	S55	Input Voltage	120/277/347 V
Lamp Type	150W HPS	Input Frequency	60 Hz
Number of Lamps	1 piece/unit	Input Current (Open Circuit)	2.8/1.25/0.92 A
Circuit Type	HX-HPF	Input Current (Starting)	2/0.85/0.52 A
Ballast Type	Magnetic HID	Input Current (Short Circuit)	1.15-1.75/0.5-0.75/0.4-0.6 A
Base Model	71A81A2	Secondary Short Circuit Current	3.95-4.85 A
Core Size	3 X 4 (2 coil)	Constant Wattage Deviation	Within Trapezoid
Suitable For Outdoor Use	Yes	Ballast Factor (Nom)	1
Ignitor Catalog Number	LI551-H4	Power Factor (Nom)	0.90
Ignitor Temperature Rating	105°C	Open Circuit Voltage	120 V
Capacitor Value	14 MFD	Input Current (Nom)	1.65/0.72/0.56 A A
Capacitor Catalog Number	7C140M30RA	Input Power (Nom)	188 W
Capacitor Requirements	280V	Rated Lamp Power	150 W
Capacitor Temperature Rating	105°C		
Capacitor Diameter/Oval Dimensions	1.65 in	Wiring	
Capacitor Height	2.75 in	Wire Striplength	0.5 mm
Automatic Restart	No	Wire Length by Color	12"
		Wire Type	Stranded
		Remote Wiring Configuration Allowed	Yes

Core & Coil (71A) HPS ~LT~ 200W

Max Ballast-Lamp Distance Remote	2'
Wiring	
Recommended Fuse Value	10/4/3 A

Approval and Application

Open Circuit Voltage Test (Volts)	110-130 V
Approval Marks	ULR CSA certificate RoHS Compliant
Temperature Marking	D/D/D
UL Recognized	Yes
Hipot Test (1 Minute)	2000 V
Hipot Test (2 Seconds)	2500 V
UL Insulation Class	H(180°C)
UL Temperature Code	1029D

Product Data

Order product name	CORE & COIL HID HPS BAL 150W S55 120/277/347V C&C
EAN/UPC - Product	781087028384
Order code	913700505211
Numerator - Quantity Per Pack	1
Numerator - Packs per outer box	4
Material Nr. (12NC)	913700505211
Net Weight (Piece)	3.552 kg

Dimensional drawing

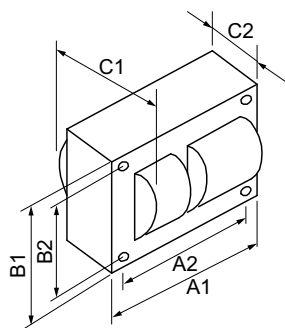

HPS BAL 150W S55 120/277/347V KIT

Product	C1	C2	A1	A2	B1	B2
CORE & COIL HID HPS BAL 150W S55 120/277/347V C&C	3.8 in	2.6 in	3.9 in	3.5 in	2.8 in	2.4 in

