

Core & Coil (71A) HPS ~LT~ 200W

CORE & COIL HID HPS BAL 150W S55 220V C&C

The basic ballast is the open core and coil which is most often used as a component within a lighting luminaire. The core and coil also forms the nucleus of Philips Advance's five other ballast configurations.

Product data

General Information	
ANSI Code	S55
Lamp Type	150W HPS
Number of Lamps	1 piece/unit
Circuit Type	HX-HPF
Ballast Type	Magnetic HID
Base Model	71A81J2
Core Size	3 X 4 (2 coil)
Suitable For Outdoor Use	Yes
Ignitor Catalog Number	LI551-H4
Ignitor Temperature Rating	105°C
Capacitor Value	14 MFD
Capacitor Catalog Number	7C140M30RA
Capacitor Requirements	280V
Capacitor Temperature Rating	105°C
Capacitor Diameter/Oval Dimensions	1.65 in
Capacitor Height	2.75 in
Automatic Restart	No
Operating and Electrical	
Input Voltage	220 V

Input Frequency	60 Hz
Inp. Current (Open Circuit)	1.5 A
Input Current (Starting)	1.1 A
Input Current (Short Circuit)	0.65-0.95 A
Secondary Short Circuit Current	3.95-4.85 A
Constant Wattage Deviation	Within Trapezoid
Ballast Factor (Nom)	1
Power Factor (Nom)	0.90
Nominal Open Circuit Voltage	120 V
Input Current (Operating) (Nom)	0.9 A A
Input Power (Nom)	188 W
Rated Lamp Watts	150 W
Wiring	
Wire Striplength	0.5 mm
Wire Length by Color	12"
Wire Type	Stranded
Remote Wiring Configuration Allowed	Yes
Max Ballast-Lamp Distance Remote Wiring 2'	
Recommended Fuse Value	4 A

Core & Coil (71A) HPS ~LT~ 200W

Approval and Application

Open Circuit Voltage Test (Volts)	110-130 V
Approbation Marks	ULR CSA certificate RoHS Compliant
Temperature Marking	C
UL Recognized	Yes
Hipot Test (1 Minute)	2000 V
Hipot Test (2 Seconds)	2500 V
UL Insulation Class	H(180°C)
UL Temperature Code	1029C

Product Data

Order product name	CORE & COIL HID HPS BAL 150W S55 220V C&C
--------------------	--

EAN/UPC - Product	781087028537
Order code	71A81J2500D
Numerator - Quantity Per Pack	1
Numerator - Packs per outer box	4
Material Nr. (12NC)	913700505281
Net Weight (Piece)	3.579 kg

Dimensional drawing

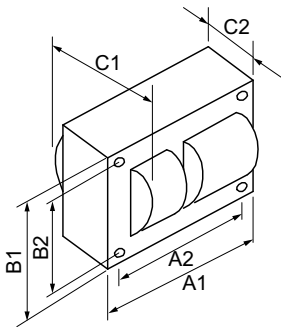

HPS BAL 150W S55 220V C&C

Product	C1	C2	A1	A2	B1	B2
CORE & COIL HID 71A81J2500D	3.8 in	2.5 in	3.9 in	3.5 in	2.8 in	2.4 in

