



Core & Coil (71A) HPS ~LT~ 200W

CORE & COIL HID HPS BAL 150W S55 220V C&C

The basic ballast is the open core and coil which is most often used as a component within a lighting luminaire. The core and coil also forms the nucleus of Philips Advance's five other ballast configurations.

Product data

General Information			
ANSI Code	S55	Input Frequency	60 Hz
Lamp Type	150W HPS	Input Current (Open Circuit)	1.5 A
Number of Lamps	1 piece/unit	Input Current (Starting)	1.1 A
Circuit Type	HX-HPF	Input Current (Short Circuit)	0.65-0.95 A
Ballast Type	Magnetic HID	Secondary Short Circuit Current	3.95-4.85 A
Base Model	71A81J2	Constant Wattage Deviation	Within Trapezoid
Core Size	3 X 4 (2 coil)	Ballast Factor (Nom)	1
Suitable For Outdoor Use	Yes	Power Factor (Nom)	0.90
Ignitor Catalog Number	LI551-H4	Open Circuit Voltage	120 V
Ignitor Temperature Rating	105°C	Input Current (Nom)	0.9 A A
Capacitor Value	14 MFD	Input Power (Nom)	188 W
Capacitor Catalog Number	7C140M30RA	Rated Lamp Power	150 W
Capacitor Requirements	280V	Wiring	
Capacitor Temperature Rating	105°C	Wire Striplength	0.5 mm
Capacitor Diameter/Oval Dimensions	1.65 in	Wire Length by Color	12"
Capacitor Height	2.75 in	Wire Type	Stranded
Automatic Restart	No	Remote Wiring Configuration Allowed	Yes
Operating and Electrical		Max Ballast-Lamp Distance Remote Wiring	2'
Input Voltage	220 V	Recommended Fuse Value	4 A

Core & Coil (71A) HPS ~LT~ 200W

Approval and Application

Open Circuit Voltage Test (Volts)	110-130 V
Approval Marks	ULR CSA certificate RoHS Compliant
Temperature Marking	C
UL Recognized	Yes
Hipot Test (1 Minute)	2000 V
Hipot Test (2 Seconds)	2500 V
UL Insulation Class	H(180°C)
UL Temperature Code	1029C

Product Data

Order product name	CORE & COIL HID HPS BAL 150W S55 220V C&C
--------------------	---

EAN/UPC - Product	781087028537
Order code	913700505281
Numerator - Quantity Per Pack	1
Numerator - Packs per outer box	4
Material Nr. (12NC)	913700505281
Net Weight (Piece)	3.579 kg

Dimensional drawing

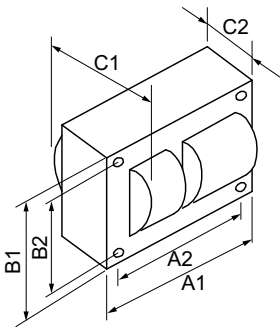

HPS BAL 150W S55 220V C&C

Product	C1	C2	A1	A2	B1	B2
CORE & COIL HID 71A81J2500D	3.8 in	2.5 in	3.9 in	3.5 in	2.8 in	2.4 in

