



Outdoor Weatherproof (79W)

OUTDOOR WEATHERPROOF HID 79W6586001

Outdoor weatherproof ballasts are designed for remote mounting outdoors under all weather conditions. They may also be placed inside a pole base, but care must be taken to avoid areas prone to flood situations as they are not water submersable.

Product data

General Information	
ANSI Code	CSI
Lamp Type	MH
Number of Lamps	1 piece/unit
Circuit Type	CWA
Ballast Type	Magnetic HID
Base Model	79W6586
Suitable For Outdoor Use	Yes
Ignitor Catalog Number	Inside Can
Capacitor Catalog Number	Inside Can
Automatic Restart	No
Operating and Electrical	
Input Voltage	120/277 V
Input Frequency	60 Hz
Input Current (Open Circuit)	9.4/4.0 A
Input Current (Starting)	8.5/3.6 A
Input Current (Short Circuit)	6.1-9.1/2.6-4.0 A
Secondary Short Circuit Current	15-23 A
Constant Wattage Deviation	10%
Ballast Factor (Nom)	1

Power Factor (Nom)	0.90
Open Circuit Voltage	200 V
Input Current (Nom)	9.8/4.2 A A
Input Power (Nom)	1150 W
Rated Lamp Power	1000 W
Wiring	
Wire Striplength	0.5 mm
Wire Length by Color	10"
Wire Type	Stranded
Remote Wiring Configuration Allowed	Yes
Max Ballast-Lamp Distance Remote Wiring	NA
Recommended Fuse Value	25/15 A
Mechanical and Housing	
Housing Material	Metal
Housing	OW
Housing Dimensions	13.8" x 6.38" x 6.38"
Approval and Application	
Open Circuit Voltage Test (Volts)	180-220 V

Outdoor Weatherproof (79W)

Approval Marks	UL certificate RoHS Compliant
Temperature Marking	Max. case temperature 90°C
UL Recognized	No
Hipot Test (1 Minute)	2000 V
Hipot Test (2 Seconds)	2500 V
UL Insulation Class	H(180°C)
UL Temperature Code	NA

Product Data

Order product name	OUTDOOR WEATHERPROOF HID 79W6586001
--------------------	--

EAN/UPC - Product	781087010082
Order code	913700506591
Numerator - Quantity Per Pack	1
Numerator - Packs per outer box	1
Material Nr. (12NC)	913700506591
Net Weight (Piece)	20.752 kg

Dimensional drawing

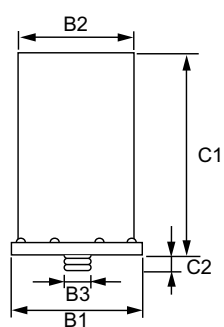

Product	B1	B2	B3	C1	C2
OUTDOOR WEATHERPROOF HID 79W6586001	7.3 in	6.4 in	1 in	13.8 in	1.9 in

MH BAL 1000W CSI 120/277V WP

