



Core & Coil (71A) MH 175W – 450W

CORE & COIL HID MH BAL 250W M58 120/277/347V C&C

The basic ballast is the open core and coil which is most often used as a component within a lighting luminaire. The core and coil also forms the nucleus of Philips Advance's five other ballast configurations.

Product data

| General Information | | Operating and Electrical | |
|------------------------------------|------------------------|-------------------------------------|--------------------------|
| ANSI Code | M58 | Input Voltage | 120/277/347 V |
| Lamp Type | 250W MH | Input Frequency | 60 Hz |
| Number of Lamps | 1 piece/unit | Input Current (Open Circuit) | 2.1/0.9/0.75 A |
| Circuit Type | CWA | Input Current (Starting) | 2.2/1/0.8 A |
| Ballast Type | Magnetic HID | Input Current (Short Circuit) | 1.9-2.7/0.8-1.2/0.65-1 A |
| Base Model | 71A57A0 | Secondary Short Circuit Current | 2.25-2.75 A |
| Core Size | 4 1/4 x 4 3/4 (2 coil) | Constant Wattage Deviation | 10% |
| Suitable For Outdoor Use | Yes | Ballast Factor (Nom) | 1 |
| Ignitor Catalog Number | NA | Power Factor (Nom) | 0.90 |
| Ignitor Temperature Rating | NA | Open Circuit Voltage | 315 V |
| Capacitor Value | 15 MFD | Input Current (Nom) | 2.5/1.1/0.9 A A |
| Capacitor Catalog Number | 7C150P40R | Input Power (Nom) | 295 W |
| Capacitor Requirements | 400V | Rated Lamp Power | 250 W |
| Capacitor Temperature Rating | 105°C | | |
| Capacitor Diameter/Oval Dimensions | 1.75 in | Wiring | |
| Capacitor Height | 3.75 in | Wire Striplength | 0.5 mm |
| Automatic Restart | No | Wire Length by Color | 12" |
| | | Wire Type | Stranded |
| | | Remote Wiring Configuration Allowed | Yes |

Core & Coil (71A) MH 175W - 450W

| | |
|----------------------------------------------------------------|------------------------------------|
| Max Ballast-Lamp Distance Remote Wiring Determined by AWG used | |
| Recommended Fuse Value | 8/3/3 A |
| Approval and Application | |
| Open Circuit Voltage Test (Volts) | 280-345 V |
| Approval Marks | ULR CSA certificate RoHS Compliant |
| Temperature Marking | A/A/A |
| UL Recognized | Yes |
| Hipot Test (1 Minute) | 2000 V |
| Hipot Test (2 Seconds) | 2500 V |
| UL Insulation Class | H(180°C) |
| UL Temperature Code | 1029A |

| | |
|---------------------------------|-----------------------------------------------------|
| Product Data | |
| Order product name | CORE & COIL HID MH BAL 250W M58 120/277/347V C&C |
| EAN/UPC - Product | 781087099629 |
| Order code | 183103 |
| Local order code | 183103 |
| Numerator - Quantity Per Pack | 1 |
| Numerator - Packs per outer box | 4 |
| Material Nr. (12NC) | 913700508731 |
| Net Weight (Piece) | 4.695 kg |

Dimensional drawing

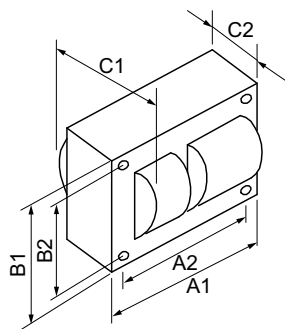

MH BAL 250W M58 120/277/347V C&C

| Product | C1 | C2 | A1 | A2 | B1 | B2 |
|-----------------------------|--------|---------|--------|--------|--------|--------|
| CORE & COIL HID 71A57A0500D | 3.1 in | 1.64 in | 4.8 in | 4.4 in | 4.3 in | 3.9 in |

