



# Core & Coil (71A) LPS

## CORE & COIL HID LPS BAL 18W L69 120/277V C&C

The basic ballast is the open core and coil which is most often used as a component within a lighting luminaire. The core and coil also forms the nucleus of Philips Advance's five other ballast configurations.

### Product data

General Information			
ANSI Code	L69	Constant Wattage Deviation	10%
Lamp Type	18W LPS	Ballast Factor (Nom)	1
Number of Lamps	1 piece/unit	Power Factor (Nom)	0.90
Circuit Type	HX-HPF	Open Circuit Voltage	315 V
Ballast Type	Magnetic HID	Input Current (Nom)	0.27/0.12 A A
Base Model	71A0280	Input Power (Nom)	30 W
Core Size	3 X 4 (2 coil)	Rated Lamp Power	18 W
Suitable For Outdoor Use	Yes	Wiring	
Capacitor Value	5 MFD	Wire Striplength	0.5 mm
Capacitor Catalog Number	7C050L30RA	Wire Length by Color	12"
Capacitor Requirements	250V	Wire Type	Stranded
Capacitor Temperature Rating	105°C	Remote Wiring Configuration Allowed	Yes
Capacitor Diameter/Oval Dimensions	1.25 in	Max Ballast-Lamp Distance Remote Wiring	Determined by AWG used
Capacitor Height	2.25 in	Recommended Fuse Value	3/2 A
Automatic Restart	No	Approval and Application	
Operating and Electrical		Open Circuit Voltage Test (Volts)	280-350 V
Input Voltage	120/277 V	Approval Marks	ULR CSA certificate RoHS Compliant
Input Frequency	60 Hz	Temperature Marking	A/A
Input Current (Open Circuit)	0.85/0.40 A	UL Recognized	Yes
Input Current (Starting)	0.30/0.13 A	Hipot Test (1 Minute)	2000 V
Input Current (Short Circuit)	0.1-0.2/0.05-0.1 A	Hipot Test (2 Seconds)	2500 V
Secondary Short Circuit Current	0.3-0.4 A	UL Insulation Class	H(180°C)

Core & Coil (71A) LPS

UL Temperature Code	1029A
Product Data	
Order product name	CORE & COIL HID LPS BAL 18W L69 120/277V C&C
EAN/UPC - Product	781087028056
Order code	913700527309

Numerator - Quantity Per Pack	1
Numerator - Packs per outer box	9
Material Nr. (12NC)	913700527309
Net Weight (Piece)	1.629 kg

Dimensional drawing

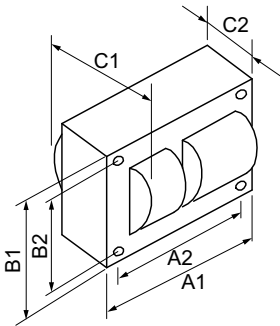

Product	C1	C2	A1	A2	B1	B2
CORE & COIL HID 71A0280500D	2.4 in	1 in	3.9 in	3.5 in	2.8 in	2.4 in

LPS BAL 18W L69 120/277V C&C

